

Manual

Articulated arm awning Alora®

Assembly & Installation Manual V.01

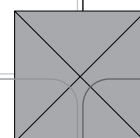

General information

Basic dimensions6

Cutting sizes9

Assembling Alora® Preparing profiles 12

Assembly of fabric roller 13

Assembly internal mechanism 14

Assembly cover support 15

Connecting cover support & top cover 17

Assembly front profile 18

Pre-adjustment..... 20

Installation of LED lighting..... 21

Assembly Alora®

Check before assembly 26

Wall mounting 27

Final adjustment 29

**** ATTENTION ****

AVZ Group cannot be held liable for any errors that may occur in this manual, nor for any adverse consequences arising from the use of this manual.



General information



Basic dimensions

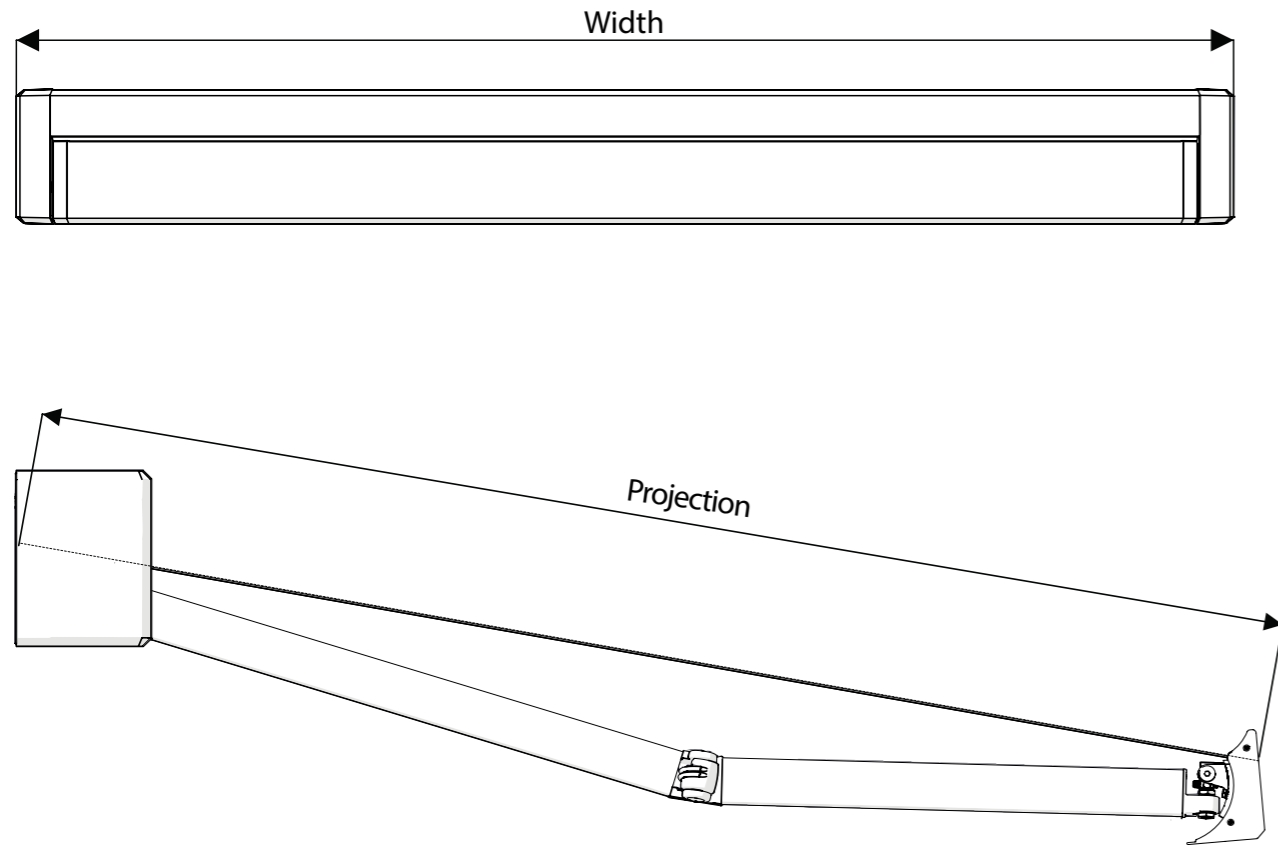

Dimensions

M-plus arms

Projected	1500 mm	2000 mm	2500 mm	2500 mm*	3000 mm	3000 mm*
Maximum width	5500 mm	5500 mm	5500 mm	5500 mm	5500 mm	5500 mm
Minimum width	1880 mm	2450 mm	3020 mm	2790 mm	3590 mm	3290 mm

* Arms with equal parts.

These arms must only be used if required to achieve the smallest width. If these arms are used for the larger widths, forces cannot be distributed evenly over the front profile. This may cause the front profile to be concave or convex. Also, the front part of the articulated arm will sag and the front profile will hang low.

Basic dimensions

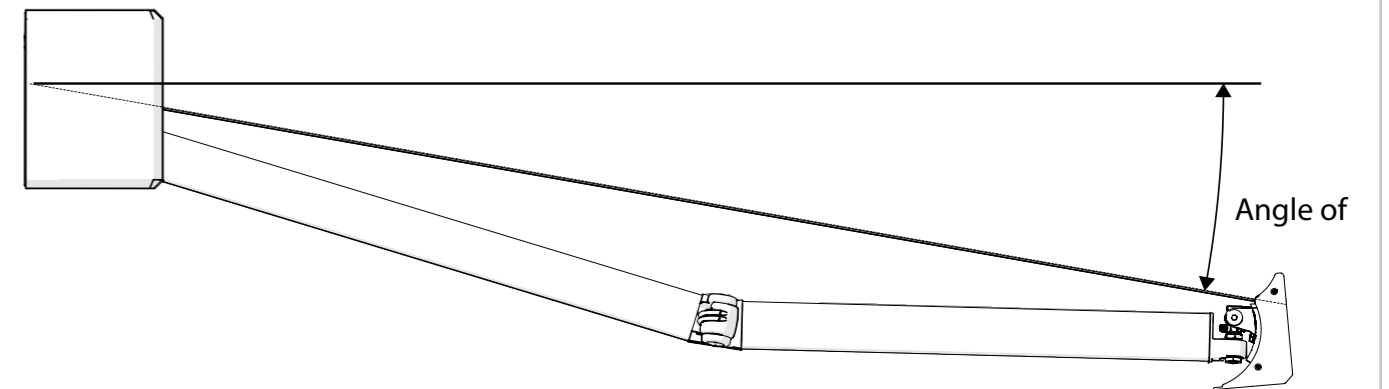

Angle of fabric
The Alora can be placed at an angle of $\pm 5^\circ$ to $\pm 35^\circ$.

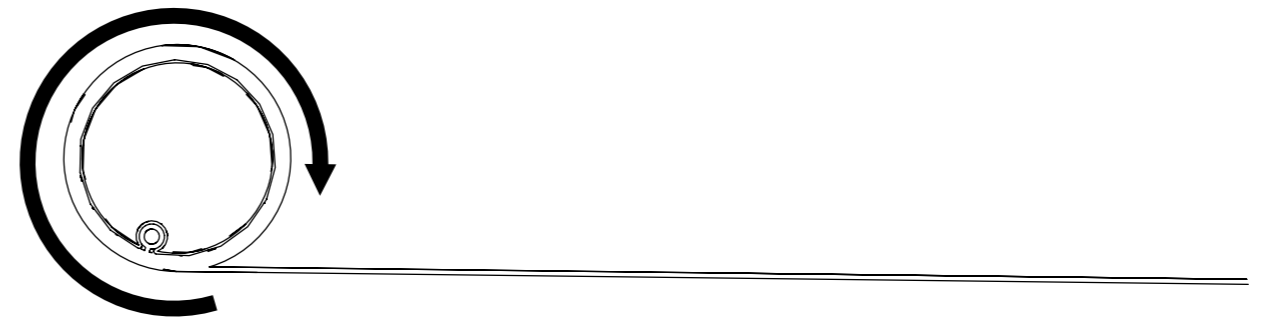



Method of rolling up the fabric
The fabric of the Alora articulated screen is to be rolled up underneath the tube.

Basic dimensions

Motor diagram

Width:	Projection 150 cm	Projection 200 cm	Projection 250 cm	Projection 300 cm
from 200 to 250 cm	25 Nm			
from 251 to 300 cm	25 Nm	30 Nm		
from 301 to 360 cm	25 Nm	30 Nm	40 Nm	
from 361 to 460 cm	25 Nm	30 Nm	40 Nm	40 Nm
from 461 to 500 cm	25 Nm	35 Nm	40 Nm	40 Nm
from 501 to 520 cm	35 Nm	35 Nm	40 Nm	40 Nm

Cutting sizes

Shape	Description	Formula	Number	Cutting size (mm)
	Top cover	Width - 120 mm		
	Bottom cover	Width - 120 mm		
	Front profile	Width - 174 mm		
	Tube 78	Width - 69 mm		
	Fabric	Width - 215 mm		
	Silicone strip LED	Width - 90 mm (Always round up from the cutting line)		

Assembly Alora[®]



Preparing the profiles

1.0 Preparing the profiles

Cut profiles & steel tube to the correct lengths (see cutting sizes).

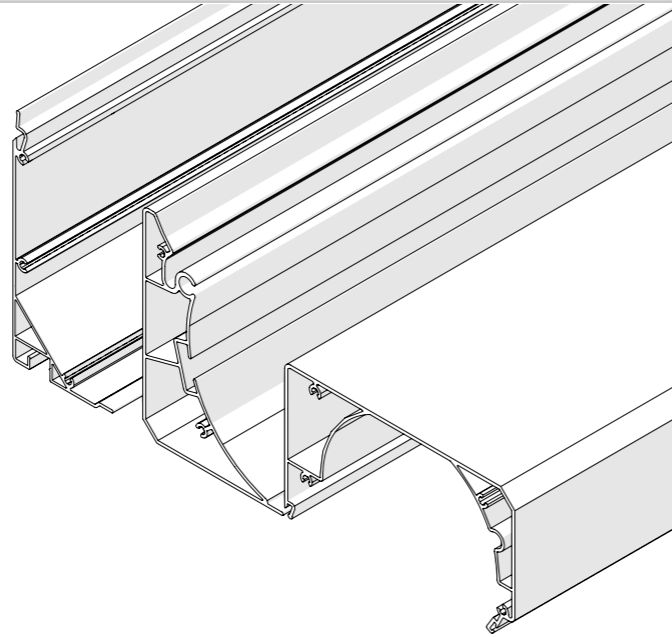

Caution! It is very important that the top and bottom covers are cut at right angles on both sides. This is necessary to keep the cover supports and articulated arms parallel.

Assembling the fabric roller tube

2.1 Filing fabric roller tube

File in the fabric slot of the fabric roller tube. In this way, the fabric will not be damaged.

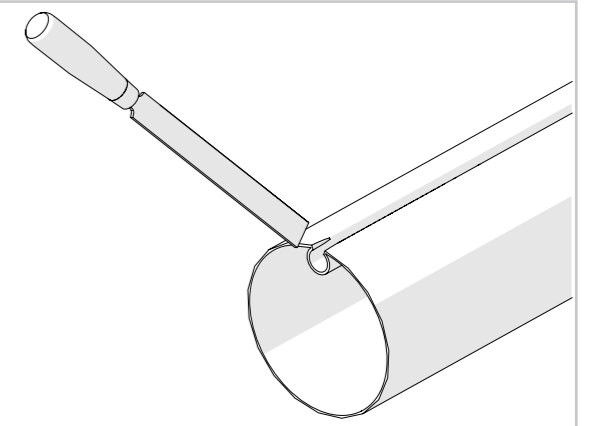

2.2 Attaching the fabric to the fabric roller tube

Insert the fabric tendon into the fabric and pull the fabric into the fabric slot of the steel fabric roller tube. Then roll up the fabric underneath the roller tube.

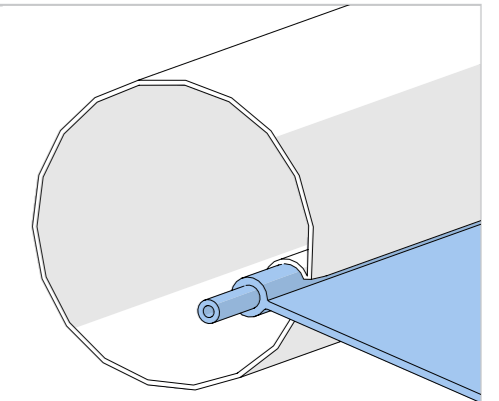
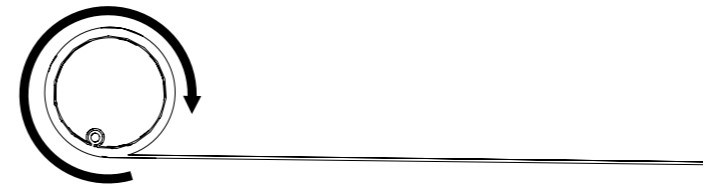

2.3 Installing the fabric clamps

Centre the fabric and place the fabric clamps at the ends.

Do not overtighten the screws.

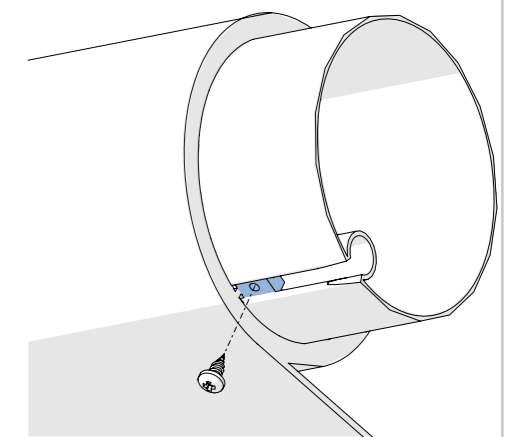

Assembly internal mechanism

3.1 Installation of the bearing cap

Place the bearing clamp with bearing on the non-operating side in the top tube.

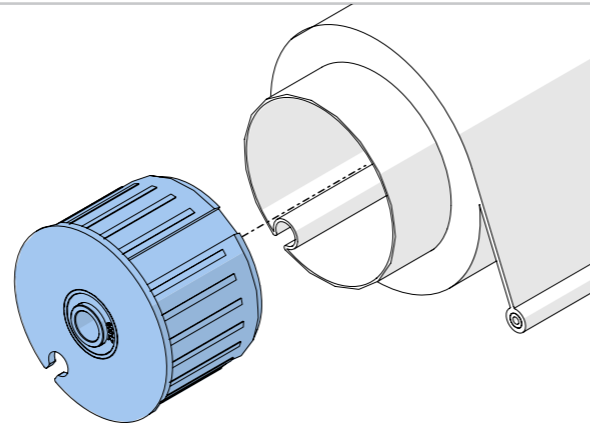

3.2 Installing the somfy motor

Place the Somfy motor on the operating side in the top tube.

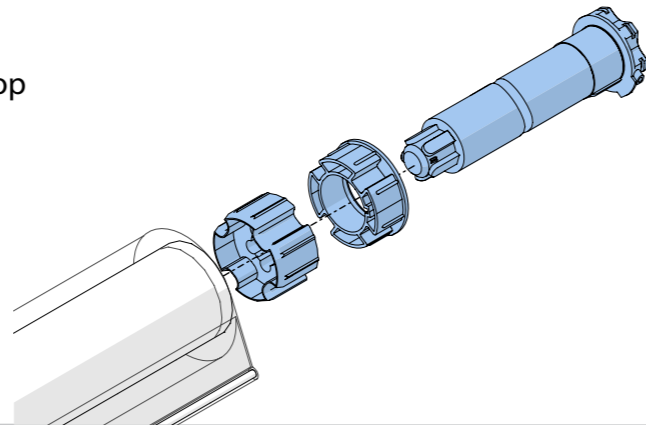

Assembly cover support

4.1 Mounting the bearing pin

Mount the bearing pin to the bearing/motor bracket with hex bolt M6 x 10mm.

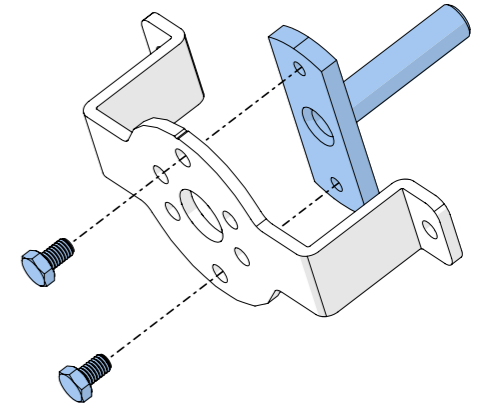

4.2 Mounting of motor bracket

Mount the bearing pin to the bearing/motor bracket with hex bolt M6 x 10mm.

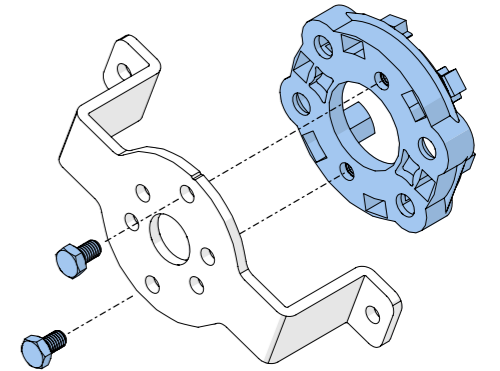

4.3 Installing the motor bracket

Using 2x hex bolt M6x12 mm, mount the bearing/motor bracket with motor adapter to the cover support on the operating side.

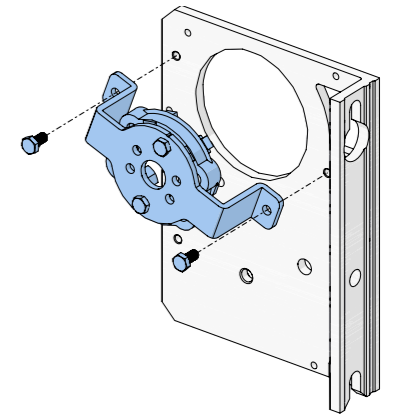

4.4 Installing bearing bracket

Using 2x hex bolt M6 x 12 mm, mount the bearing/motor bracket with bearing pin to the cover support on the bearing side.

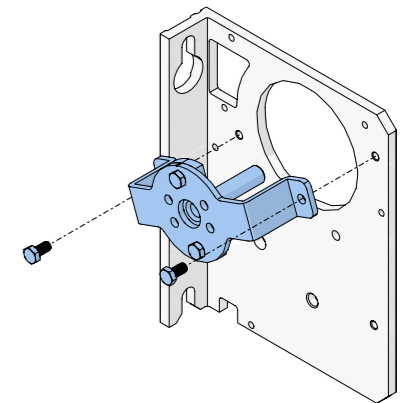

Assembly cover supports

4.4 Mounting arm holder

Using the eccentric pin, mount the arm holder to the arm. Then install the front profile into the nosepiece by turning the bushing and nut against each other.

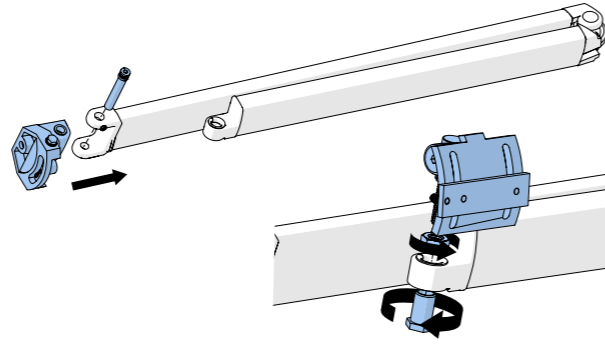

4.5 Mounting arms

Using hex bolt M10 x 45 mm and M10 x 30 mm, mount the arms to both cover supports.

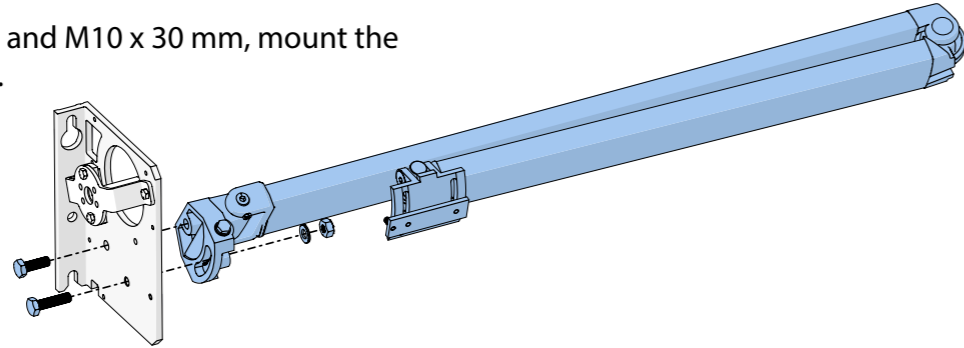

4.6 Installation of guide wheels

Place the guide wheel on the two cover supports.

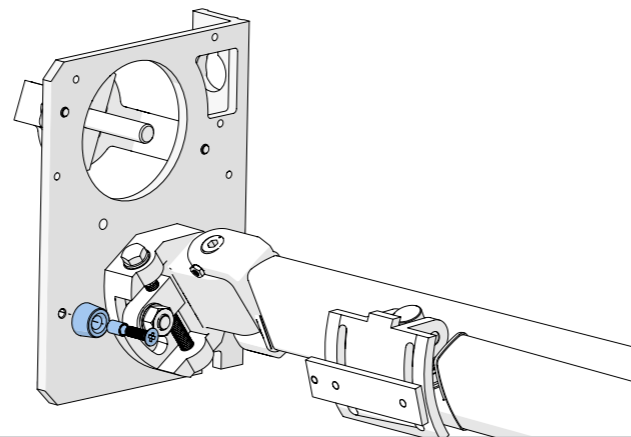

4.7 Open up the arms

Open up the arms partly by replacing the plastic strap with a wider strap.

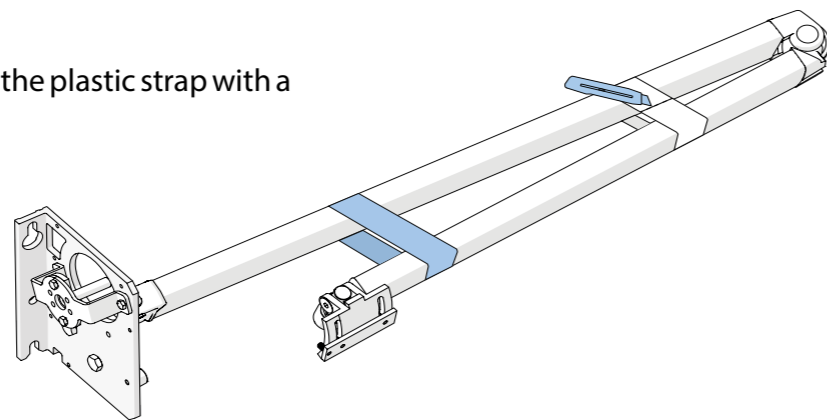

Joining cover supports - top cover

5.1 Fitting of plastic seal

Slide the plastic seal into the top cover.

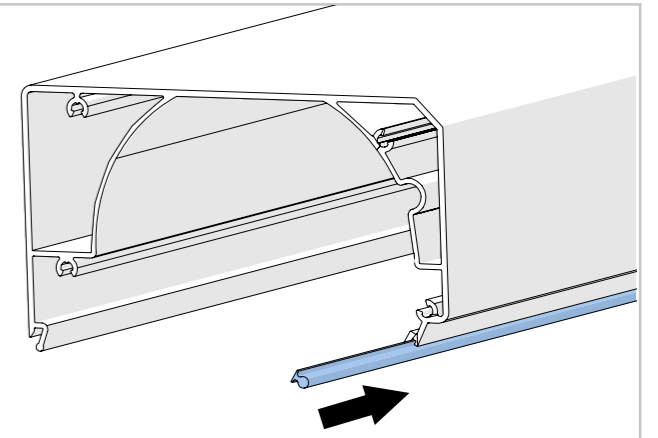

5.2 Installing fabric roller

Insert the fabric roller into the top cover and hook the bottom cover into the top cover. Make sure that the fabric is directed upwards.

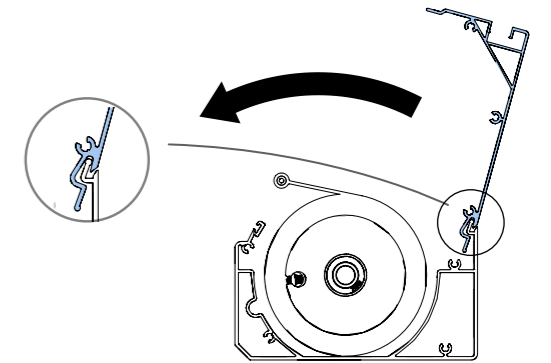

5.3 Mounting cover support bearing side

Mount the cover support with self-tapping screw 7 x (cylinder head/cross-head) 4.2 mm x 32 mm to the top cover. In doing so, insert the bearing pin into the bearing of the bearing prop.

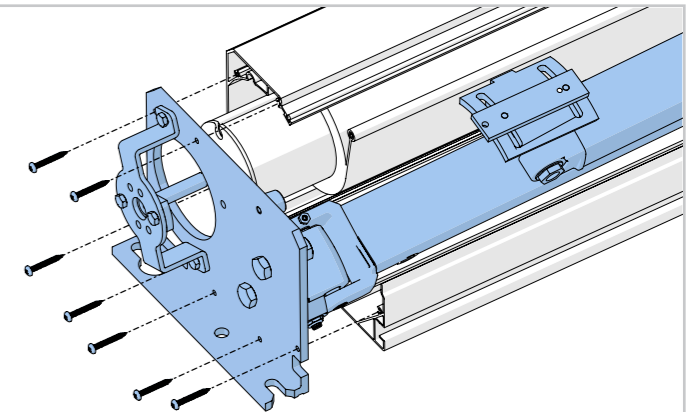

5.4 Mounting cover support motor side

Mount the cover support with self-tapping screw 7 x (cylinder head/cross-head) 4.2 mm x 32 mm to the top cover. In doing so, insert the motor into the adapter.

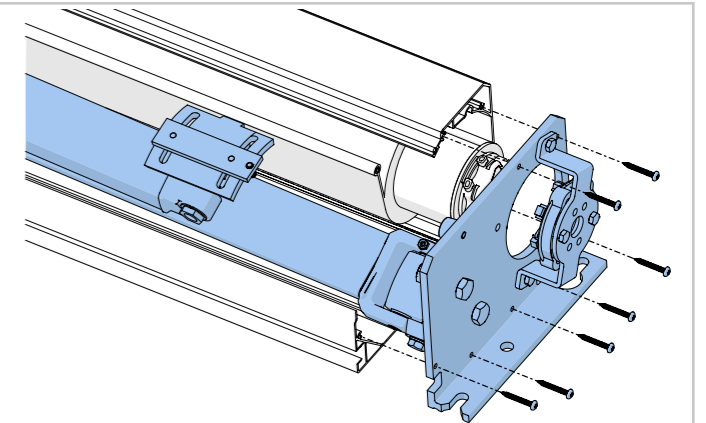

Assembly front profile

6.1 Loosen bolts of mounting plate

Loosen the hex bolts of the front profile connection to allow some space.

The mounting plate must be able to move up and down through the slots.

Do this on both arms.

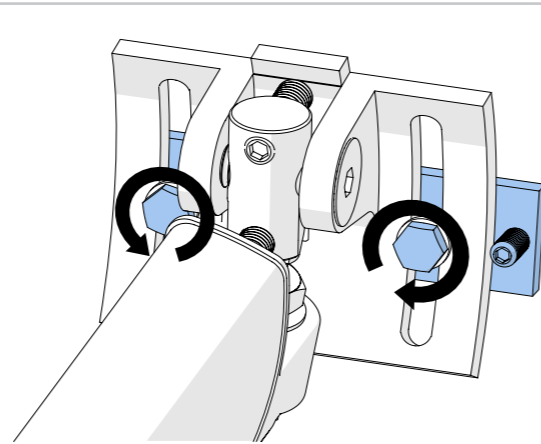

6.2 Push the front profile over the fabric

Connect the front profile to the fabric by sliding it over the fabric.

At the same time, slide the front profile mounting plate into the front profile.

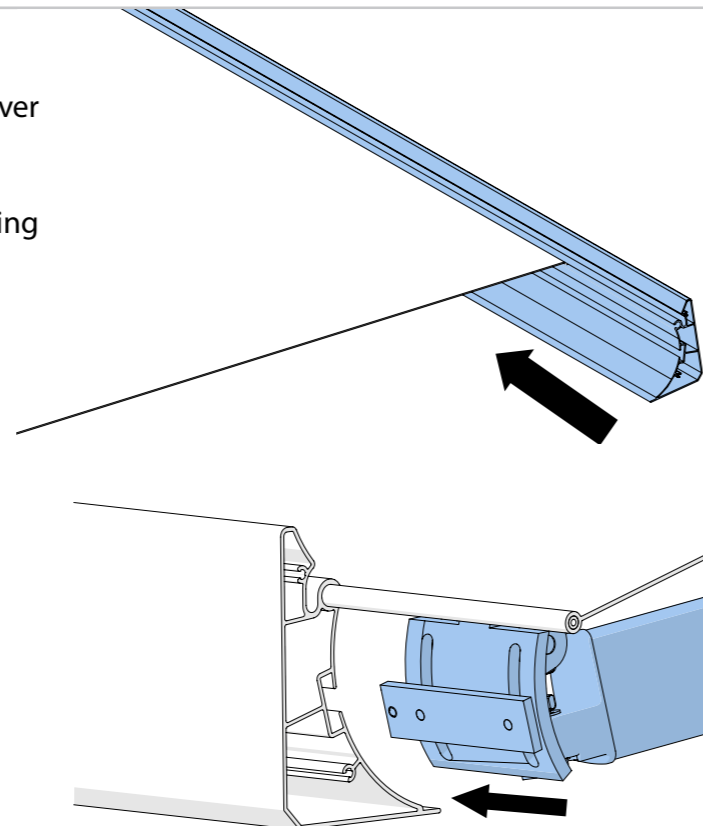

6.3 Fabric clamps

Place the fabric clamps; do not tighten yet.

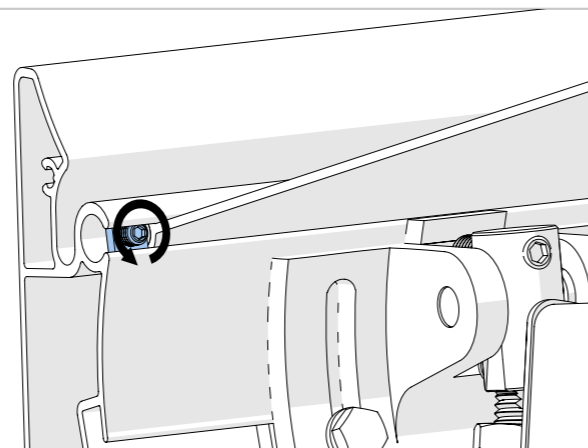

6.4 Positioning of the front profile caps

Place the front profile caps and secure them with self-tapping screws 2x4.2x32 mm (countersunk head/cross-head).

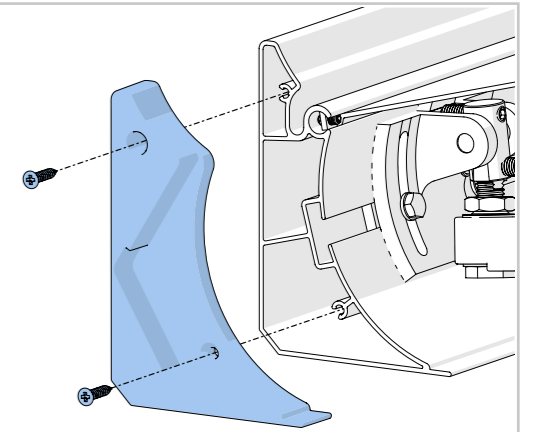

6.5 Centring the front profile

Centre the front profile between the two cover supports.

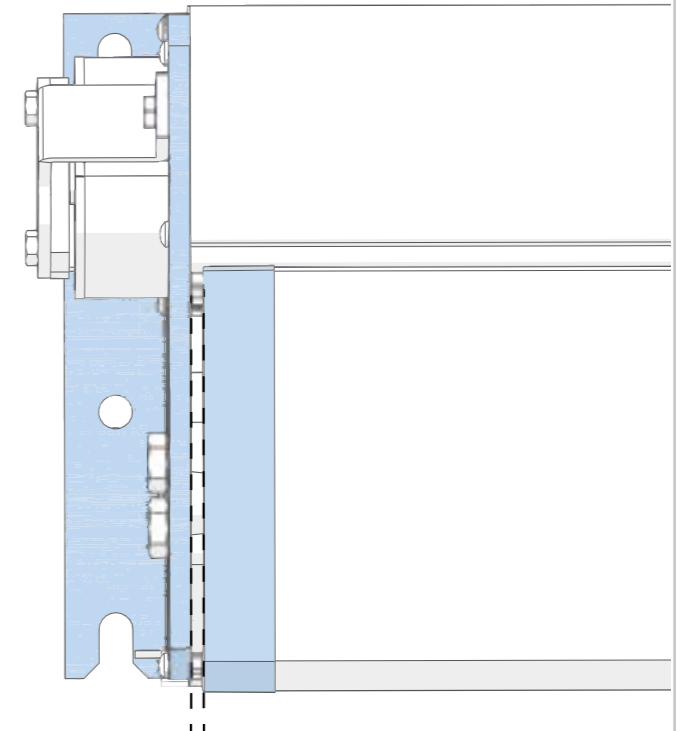
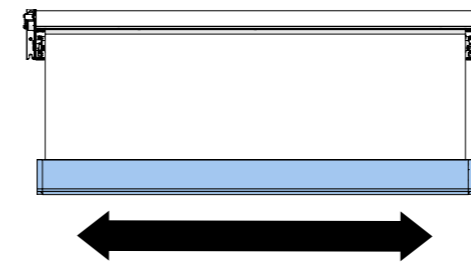

6.6 Fixing the position of the front profile

After centring, secure the front profile with the hex bolt.

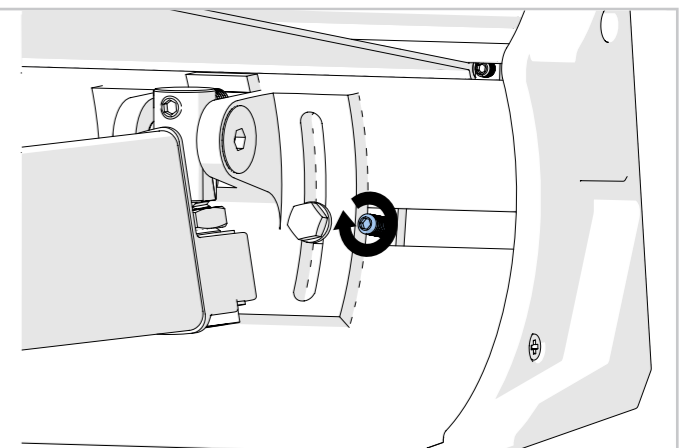

Pre-adjustment

7.1 Aligning front profile

Align the front profile so that it follows the contour of the cover supports and temporarily secure it.

The front profile will eventually be adjusted when mounting the screen.

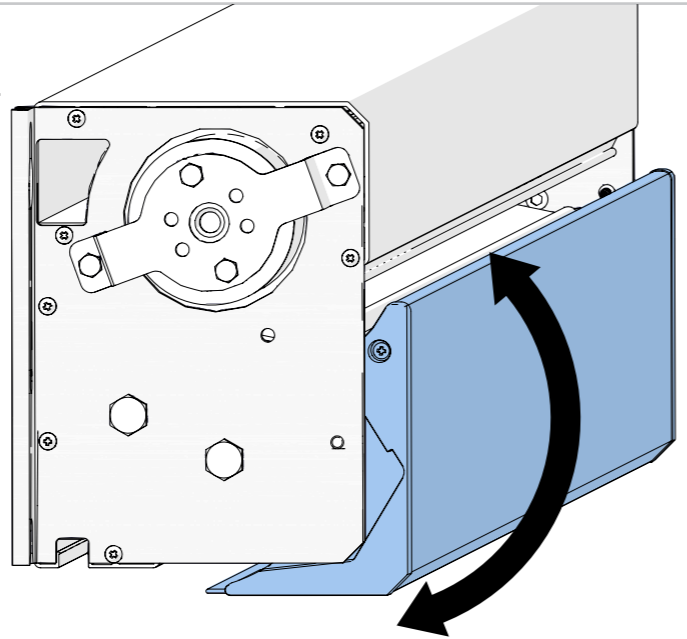
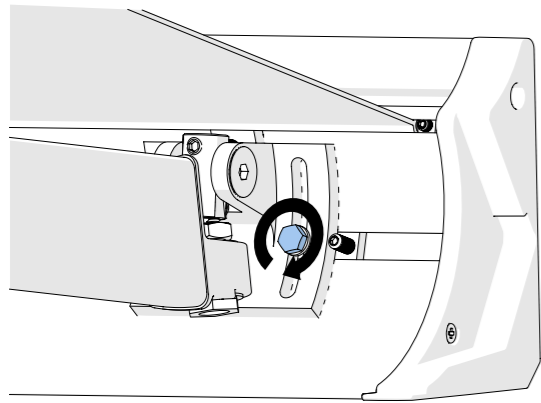

7.2 Close screen

Close the screen and check that it is closed properly. The covers must not be installed until the screen is mounted.

Mounting LED lighting

8.1 Removing the cable

Remove the cable with connector from the transformer. ATTENTION! Save the cable for future use.

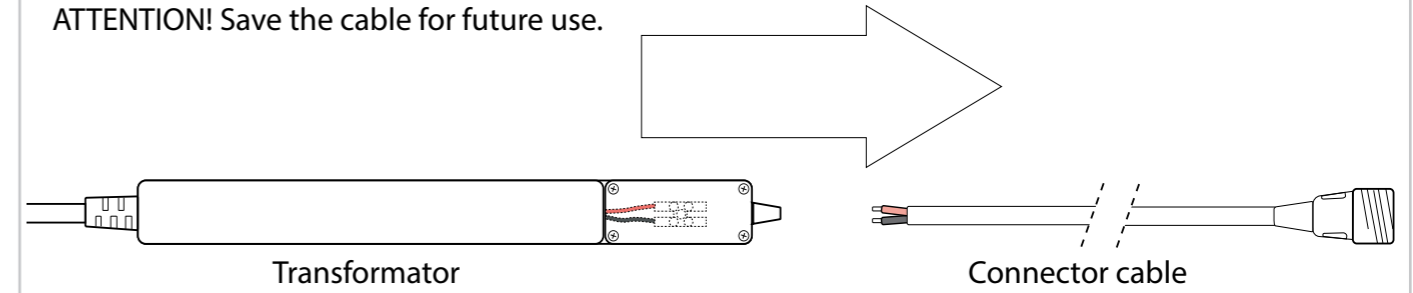

8.2 Connecting the wiring

Connect the wires according to the diagram below. For more details, please refer to the manual of the individual components.

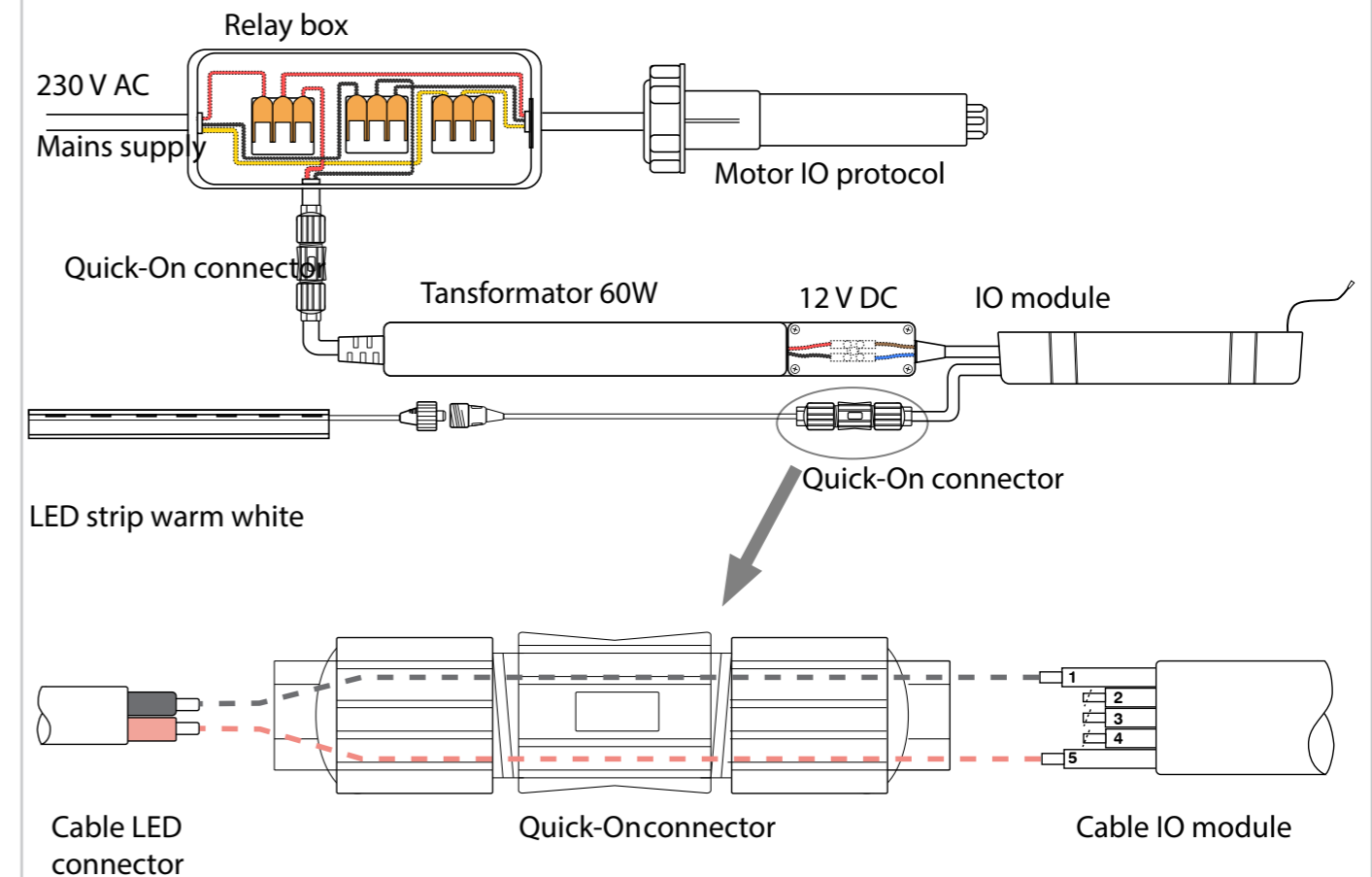

Installation of LED lighting

8.2 Installation of LED strip

Press the silicone strip into the intake of the bottom cover. The strip will overlap the cover support on both sides.

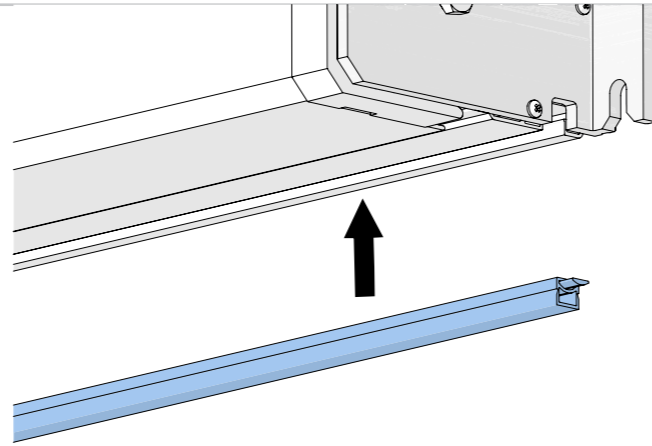

8.3 Installing the electrical package

Install the electrical package as shown in the illustration. In doing so, slide the transformer and IO receiver into the opening of the cover support.

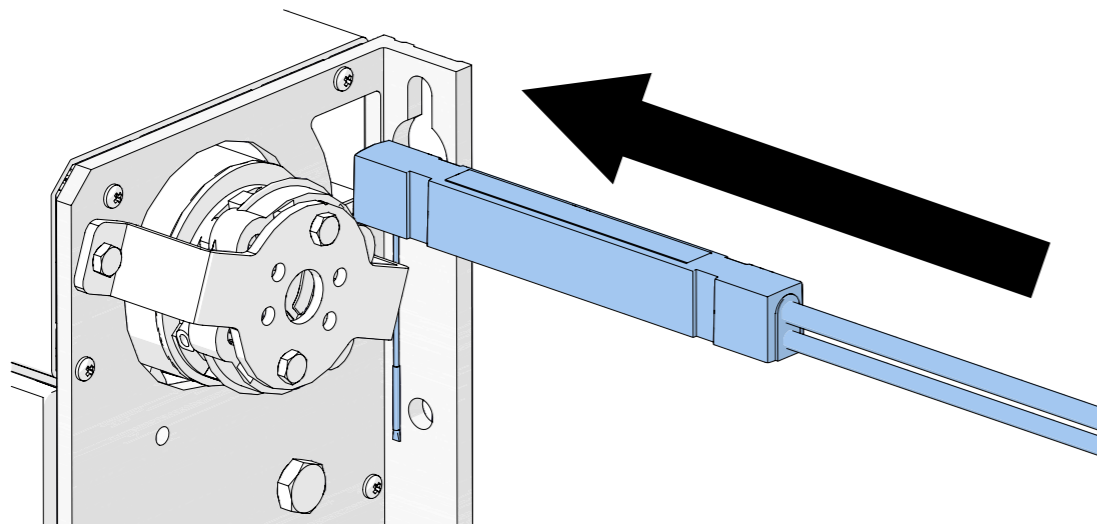
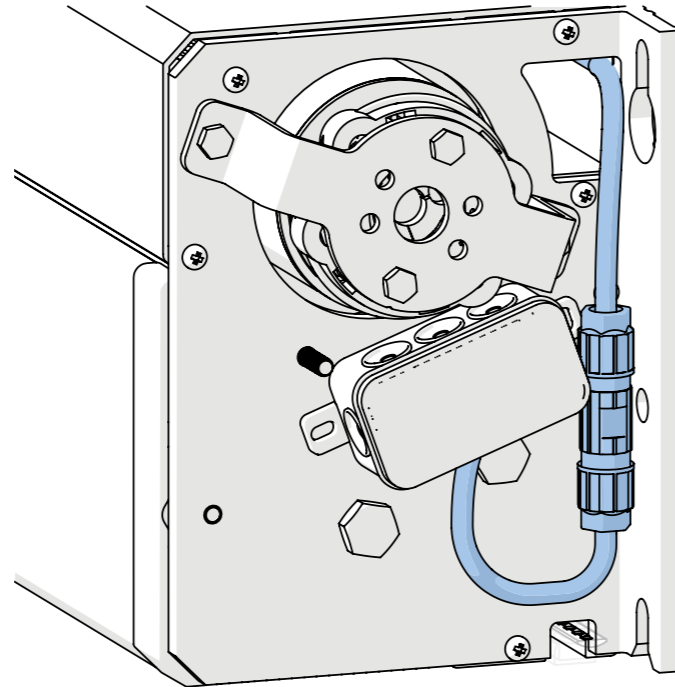

8.4 Connecting power supply

Connect the screen to the manual transmitter. Next, use the connector to apply voltage to the lights to connect them to the manual transmitter.

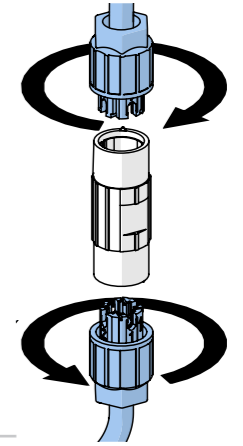

8.5 Close screen

Close the screen and check that it is closed properly. The covers must not be installed until the screen is mounted.

Assembly Alora[®]



Check before assembly

1.1 Check the structural situation

Before installing the screen, check whether the existing building is suitable for mounting an articulated screen.

If necessary, have a structural engineer assess the situation.

1.2 Fasteners

Provide adequate fasteners for the wall and articulated screen combination you are using.

Ask your fastener supplier for advice.

The cover support is made to fit M10

Wall mounting

2.1 Drilling cable hole

For electric operation: drill a hole through the wall for the power cable.

2.2 Preparing wall

Insert 4 M10 mounting points into the wall. Make sure they are level both horizontally and vertically.

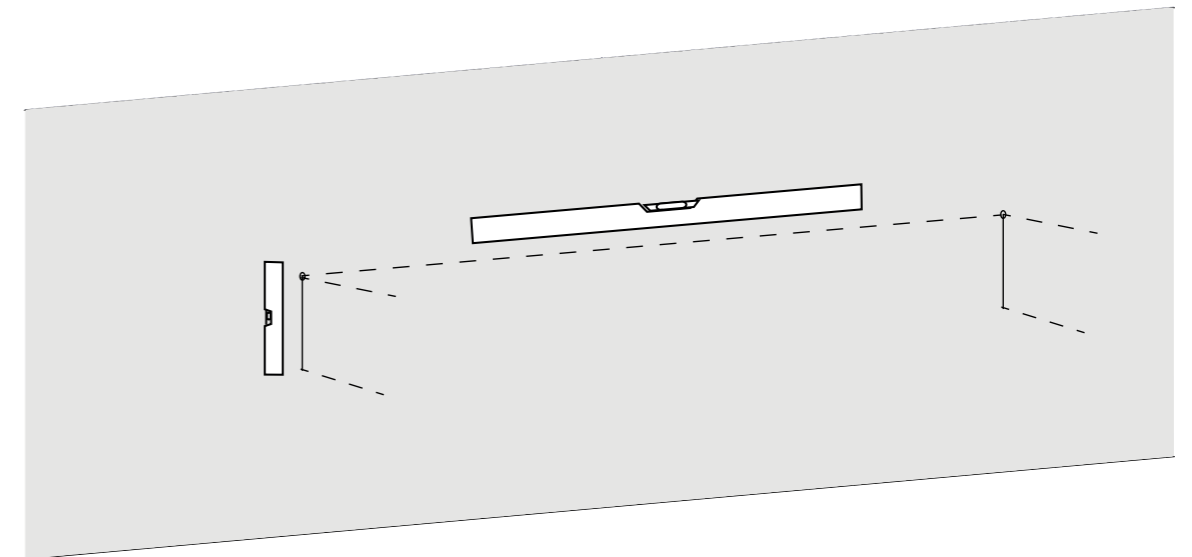

2.3 Screen installation

Place the articulated arm awning over the attachment points. Then secure it in place.

Make sure the screen's projection is level.

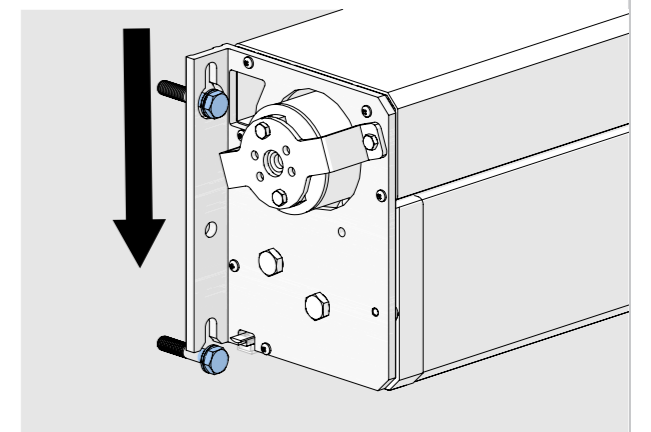

3.2 Connecting the motor

Use the installation instructions of the selected motor when connecting the motor.

4.1 Adjusting the screen angle

Adjust the screen angle between 5° and 35°. Adjust the screen by slightly loosening the arm holder bolts.

Tip: Slightly lift the front profile so that the bolt can be easily loosened.

The adjustment bolt can then be turned in and out.

Make sure that the front profile is parallel to the top cover in the projected position. Once the desired position has been reached, retighten the bolts.

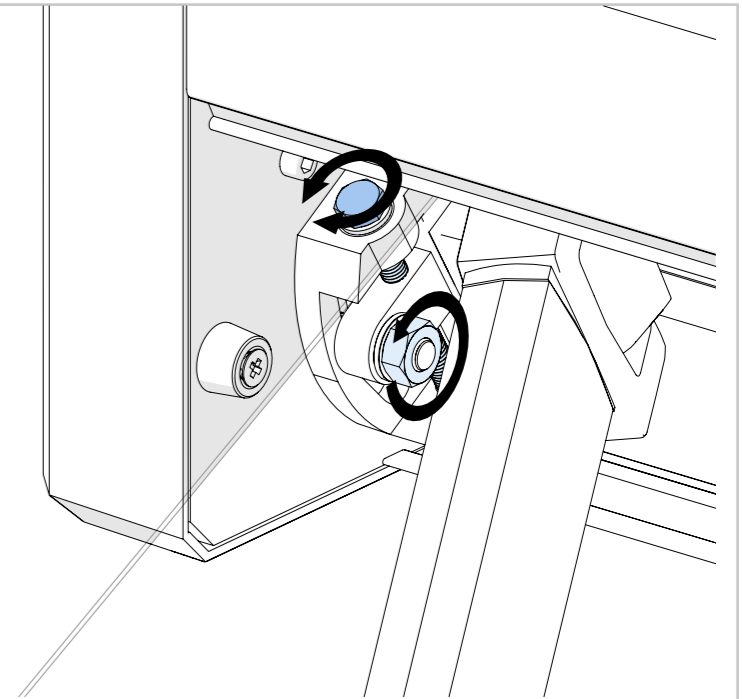

4.2 Adjusting the front profile

Close the screen until about 30 cm is still projected. Now align the front profile so that it follows the contours of the cover supports.

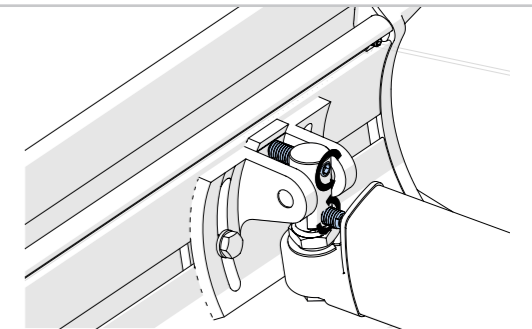
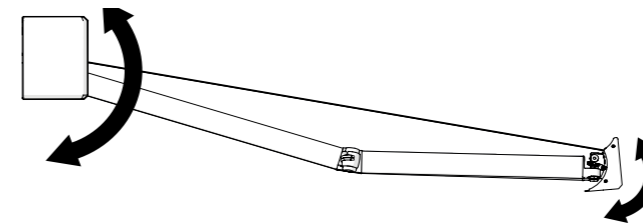

3.1 Fit the cover

Place the cover over the cover support and secure with Allen screw M6 x 25mm (cylinder head)

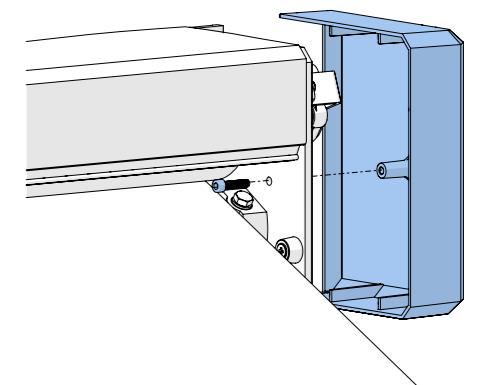

Final adjustment

4.3 Check the closed position

Close the screen completely and check if the front profile falls into place.

Check that the front profile follows the contours of the cover supports. If not, please adjust.

4.4 Electric control

For electric operation, adjust the motor using the operating instructions for the selected motor.

Annexes



Articulated arm awning Alora®

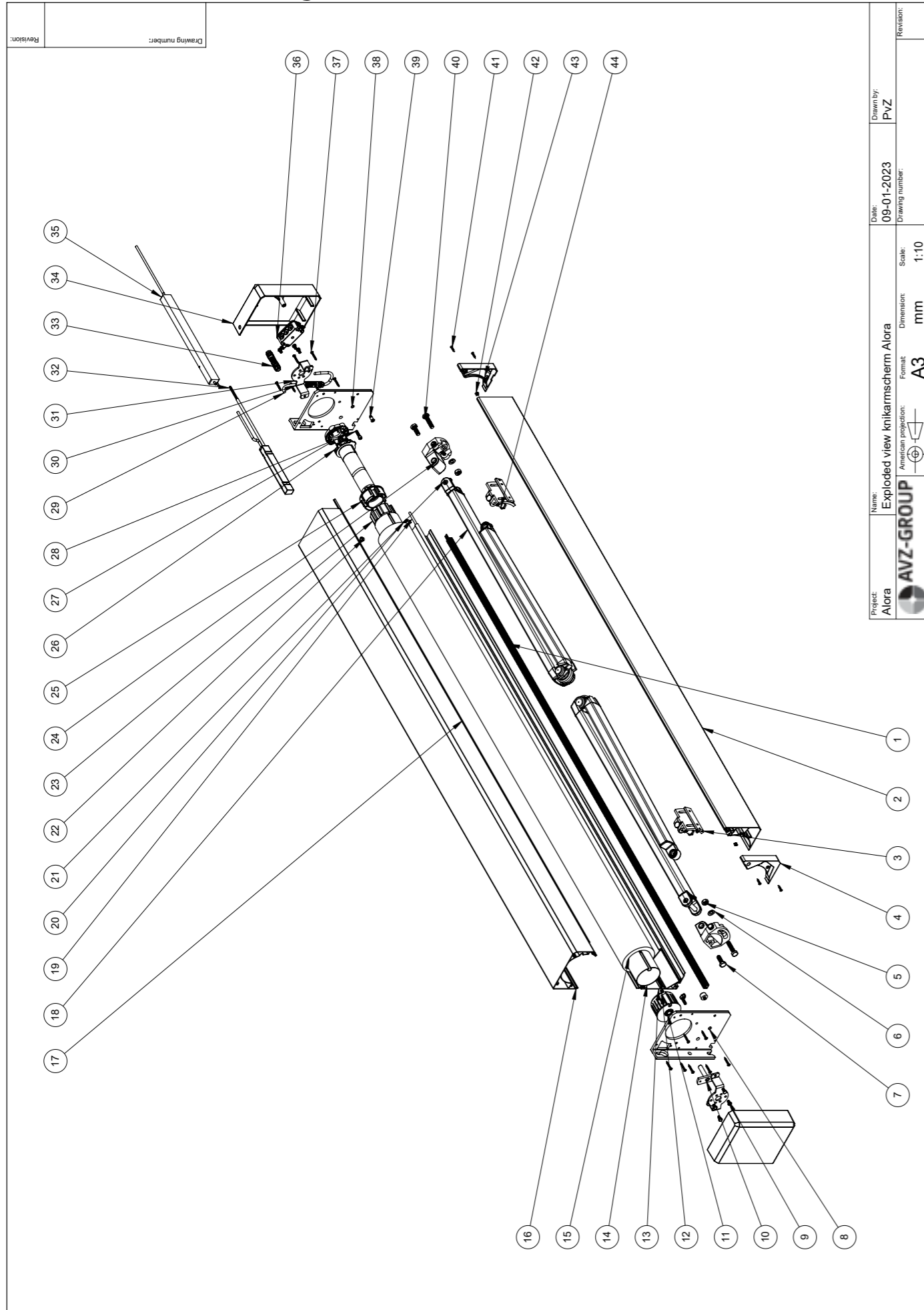

44	1011951	"Front profile connection M-plus Furore - Premier - right"	1
43	1039596	End cap for front profile Alora	1
42	1000315	Nut M5 DIN562 stainless steel A2	4
41	1003591	Self tapping screw 4,2x22 (countersunk/crosshead) DIN7982 RVS-A2	4
40	2001442	Stud M10x45 DIN933 stainless steel A2	2
39	1004616	Roller front profile Furore - Primo - Linea	2
38	1021773	Cover support Alora compact arm - right	1
37	1001980	Self tapping screw 4,2x32 (cylinder head/cross head) DIN7981 RVS-A2	14
36	1002199	Junction box Cubola wall section	1
35	2001706	Power supply 60W led lighting	1
34	1021739	Cover Alora universal	2
33	1000357	Quickon cable connector	2
32	1001440	IO receiver Warm white	1
31	2001620	Hex bolt M6x12 DIN933 SS-A2	4
30	1002611	Motor / bearing bracket high 42mm - uni	2
29	-	2-pole cable	1
28	1002943	Allen screw M6x25 (cylinder head) DIN912 SS-A2	2
27	1003426	Motor support (S)LT with locking clip and nuts	1
26	1037011	Motor Somfy IO	1
25	1000368	Adapter model AVZ for tube 78	1
24.1	1011869	Arm link 2-bs compact SIBR Alora - left	1
24.2	1011870	Arm link 2-bs compact SIBR Alora - left	1
23	1003339	Somfy carrier series 50/60 tube78	1
21	1004255	Arm connecting pin eccentric G-Plus / M-Plus	2
20	2001714	WAGO 3-Way	3
19	4000213	Fabric tendon 6.0x3.0 mm	2
18	1012297	Articulated arms M-plus 300	1
17	1011066	Sealing black for top cover	1
16	1037136	Top cover Alora	1
15	-	Fabric Alora	1
14	1012834	Steel tube 78x1.25 mm	1
13	1036984	Bottom cover Alora	1
12	1004761	Allen set screw M5x10 DIN916 SS-A2 cup point	4
11	1000738	Bearing cap 78 plastic - bearing 28mm	1
10	4210498	Bearing pin 12mm incl. mounting plate	1
9	1004771	Hex bolt M6x10 DIN933 SS-A2	4
8	1021341	Cover support Alora - left	1
7	1004625	Stud M10x30 DIN933 stainless steel A2	2
6	1003793	Revet M10 DIN 125-A	2
5	1003763	Hexagon nut M10 DIN934 stainless steel A2	2
4	1039907	End cap for front profile Alora - left extended	1
3	1011950	"Front profile connection M-plus Furore - Premier - left"	1
2	1037008	Front profile Alora	1
1	1078690	LED Strip White 5730 mm	1

Articulated arm awning Alora[®] Assembly and mounting
instructions V.01

Aluminium Verkoop Zuid B.V.
Kanaaldijk 11 • 5683 CR Best • Netherlands
T +31 499 328 600 E verkoop@avz.nl

Sun Stock Holland B.V.
Talhoutweg 16 • 8171 MB Vaassen • Netherlands
T +31 578 677 222 E info@sunstock.nl

