

Manual

SolidSky
Assembly & Installation Manual V.08



****ATTENTION****

AVZ Group cannot be held liable for any errors that may occur in this manual, nor for any adverse consequences arising from the use of this manual.

General information

Basic dimensions	6
Determining the cutting sizes	7
Side guide supports	8

SolidSky assembly

Preparation of profiles	12
Assembly of fabric roller	13
Assembly of front profile	15
Assembly of casing	17
Assembly of side guides	18

SolidSky installation

Installation of casing	24
SolidSky installation	25



General information



Basic dimensions

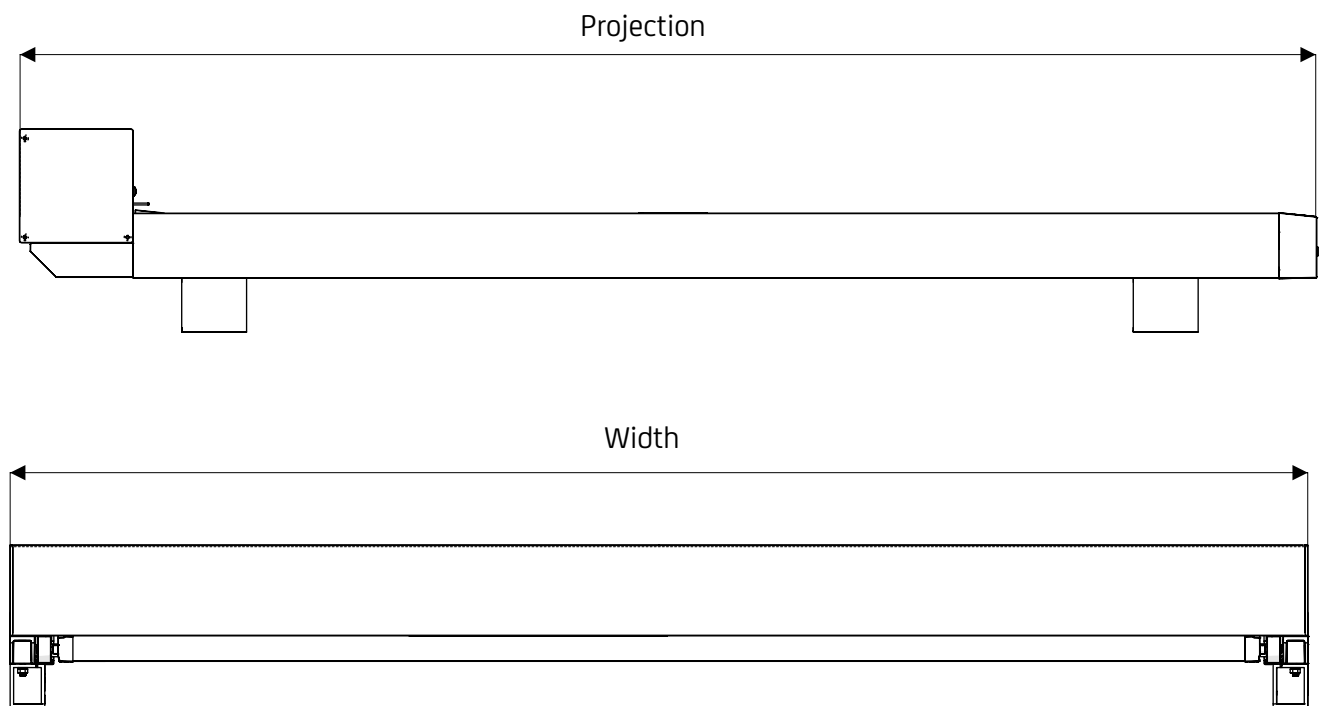

SolidSky

Width: Min. 800 mm Max. 4000 mm
Projection: Min. 1000 mm Max. 3000 mm

Up to 2000 mm always uses a motor with a torque of 20 Nm.
Number of supports: 2 pieces per side guide.

From 2000 mm always uses a motor with a torque of 25 Nm.
Number of supports: 3 pieces per side guide.

Determining the cutting sizes

Picture	Description	Formula	Number	Cutting size (mm)
	Top cover	Width - 6 mm		
	Bottom cover	Width - 6 mm		
	Front profile	Width - 145 mm		
	Steel tube 78	Somfy width - 113.5 mm ASA width - 112.5 mm		
	Side guide	Projection - 140 mm		
	Plastic guide	Projection - 150 mm		
	Fabric	Width - 70 mm Projection + 100 mm		

Soltis Lounge
Soltis 92
Soltis 86
Seamless acrylic uni fabric
Sergé screen fabric

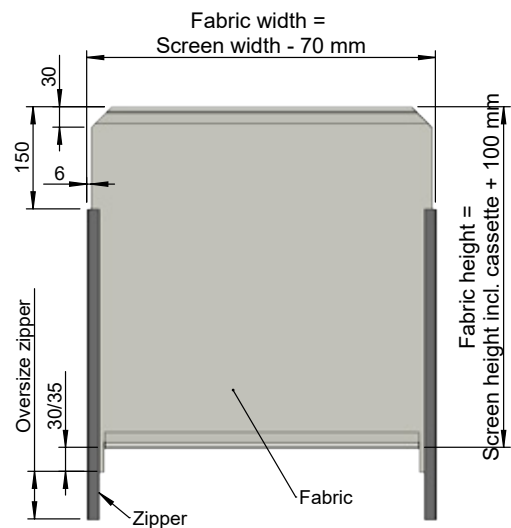

Side guide supports

Side guide support 50 high

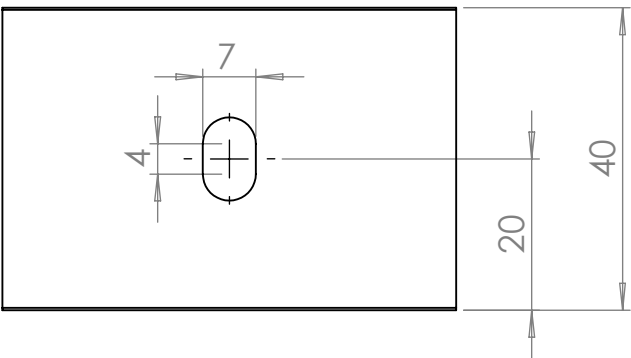
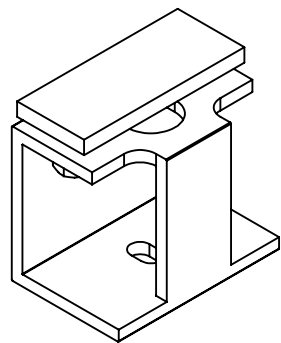
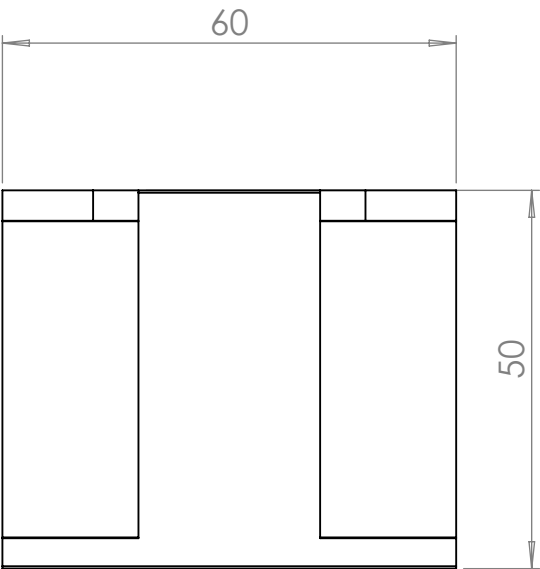
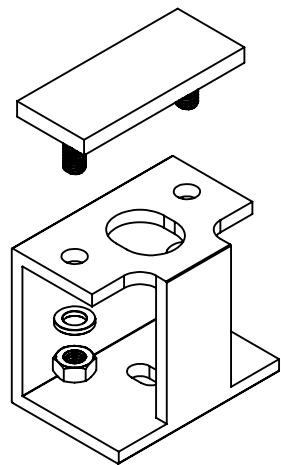

Side guide support for coupled system 50 high

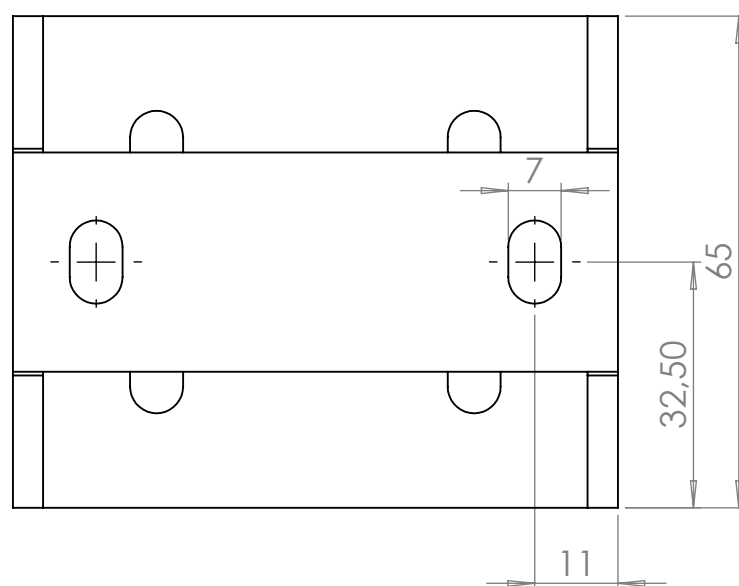
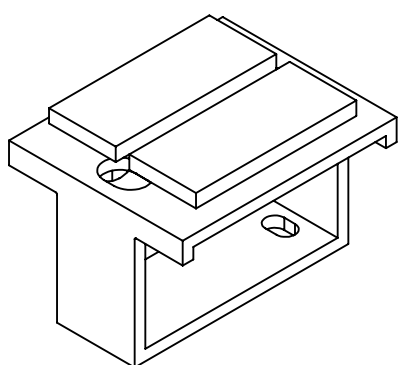
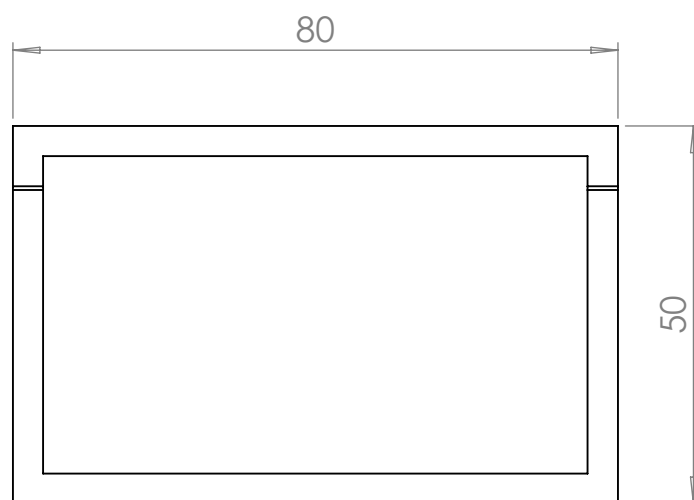
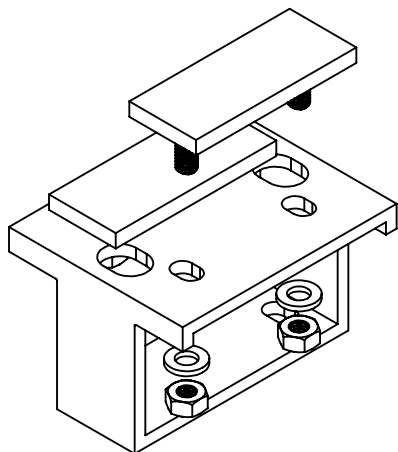

SolidSky assembly



Preparation of profiles

1.0 Preparation of profiles

Cut the profiles to size using the table on **page 7**

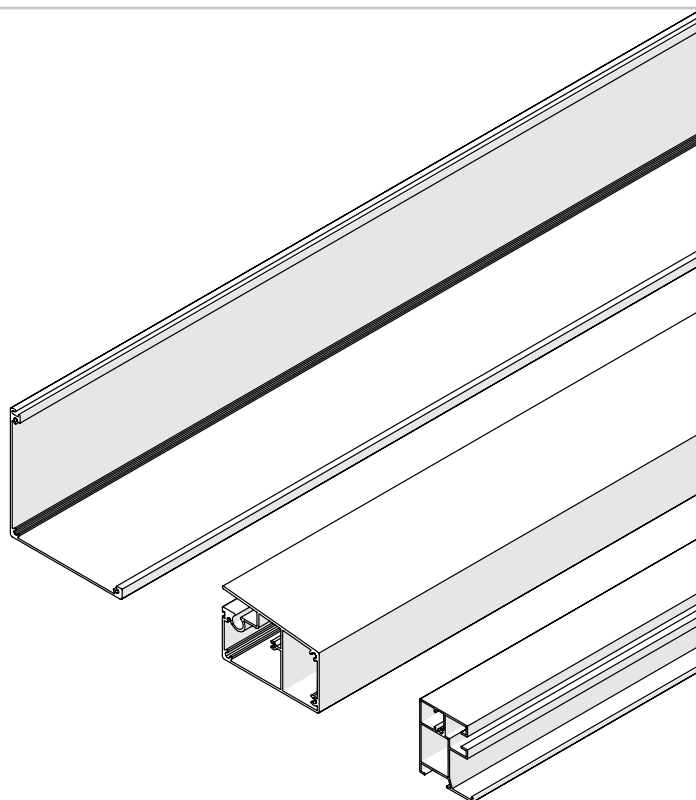

Assembly of fabric roller

2.0 Attaching the fabric to the fabric roller

Slide the fabric cords into the fabric and slide the fabric into the fabric slot. If necessary, use silicone spray to allow the fabric to slide more easily into the fabric slot.

ATTENTION! Make sure that the zipper is on the underside of the fabric and that the fabric is inserted correctly into the recessed fabric slot.

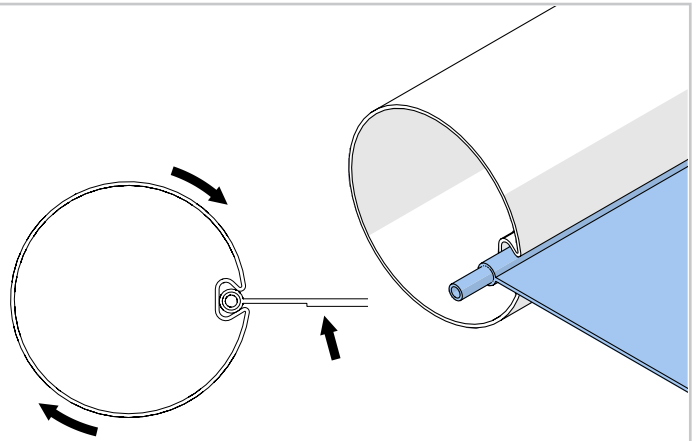

2.1 Fitting of bearing roller bung into fabric roller

Fit this as shown in the picture.

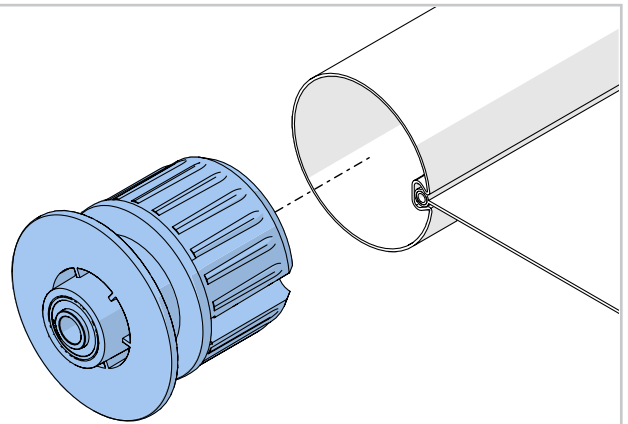

2.2 Fitting of motor in fabric roller

Place the motor in the fabric roller as shown in the picture.

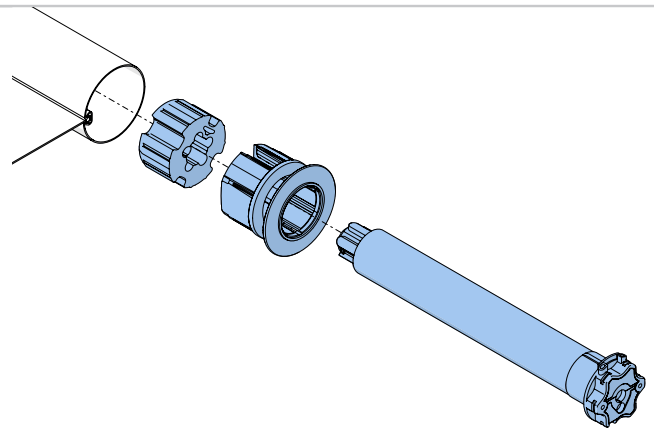

2.3 Rolling up the fabric

Roll up the fabric along the bottom with the zipper at the bottom as shown in the picture. Note: the roller has a recessed fabric slot.

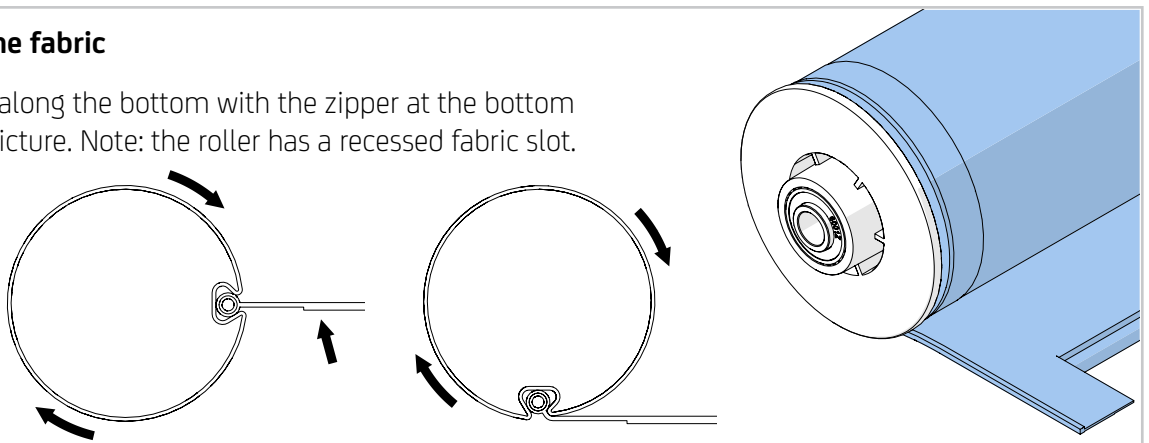

Assembly of fabric roller

2.4 Fastening of plastic mounting plate

Fasten the bearing pin to the plastic mounting plate using two M6 x 12 mm screws (countersunk head/cross-head) and place it in the fabric roller as shown in the picture.

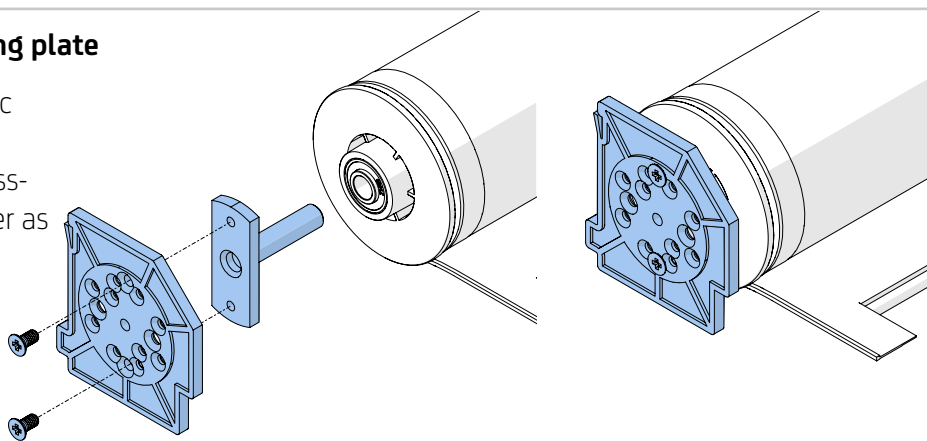

2.5 Fastening of plastic mounting plate

Fasten the plastic mounting plate to the motor using two Somfy screws.

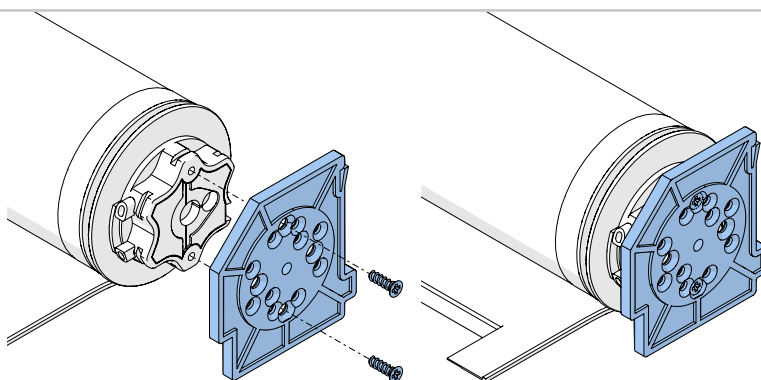

Assembly of front profile

3.0 Fitting of plastic seal

Cut the plastic seal to the same length as the front profile and slide it into the front profile as shown in the picture.

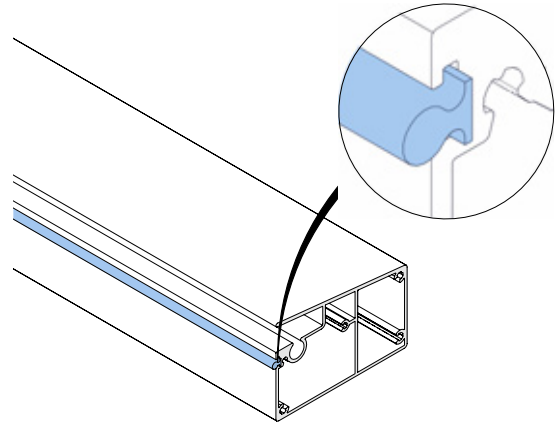

3.1 Attaching of front profile to fabric

Slide the fabric with the fabric cord into the front profile as shown in the picture.

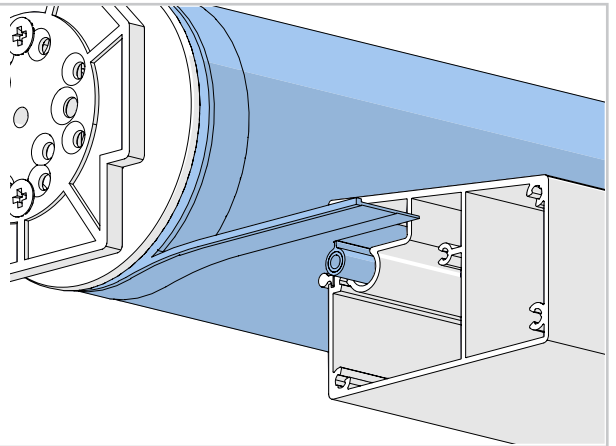

3.2 Installation of guide blocks

Install the guide blocks onto the front profile using 4.2 x 45 mm self-tapping screws (countersunk head/cross-head).

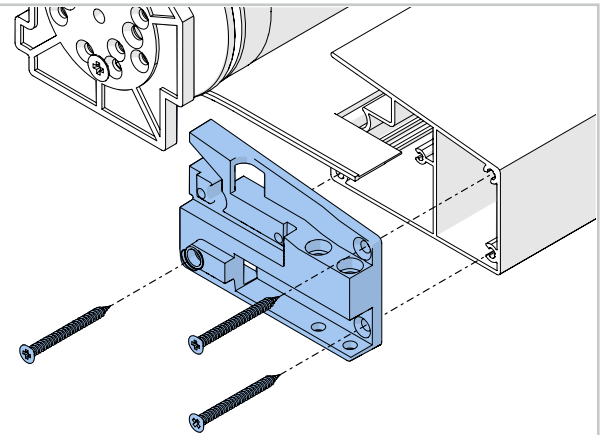

3.3 Mounting of wheels

Mount the wheels to both sides of the front profile using adapter screws as shown in the picture.

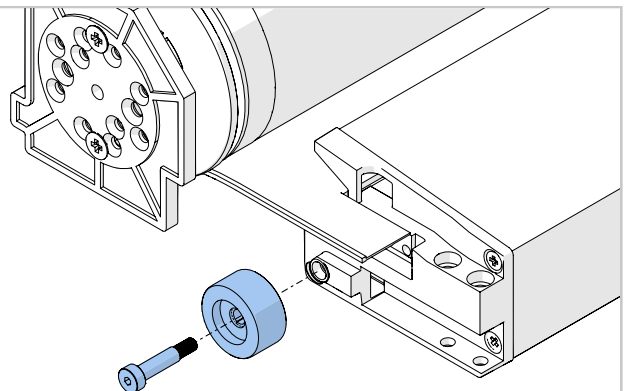

Assembly of front profile

3.4 Installation of end caps

Install the end caps onto the guide blocks using two 3.5 x 32 mm self-tapping screws (countersunk head/cross-head) on both sides of the front profile.

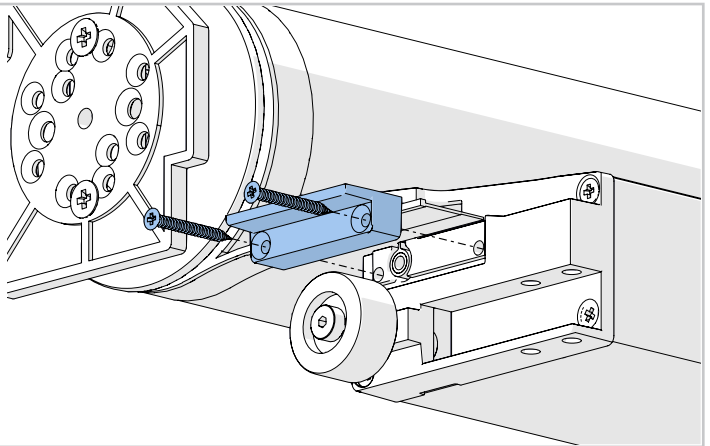

3.5 Installation of end caps

Install the other parts of the end caps onto the guide blocks using two 3.5 x 16 mm self-tapping screws (countersunk head/cross-head) on both sides of the front profile. Make sure that approximately 6 mm of fabric protrudes from the end caps on both sides.

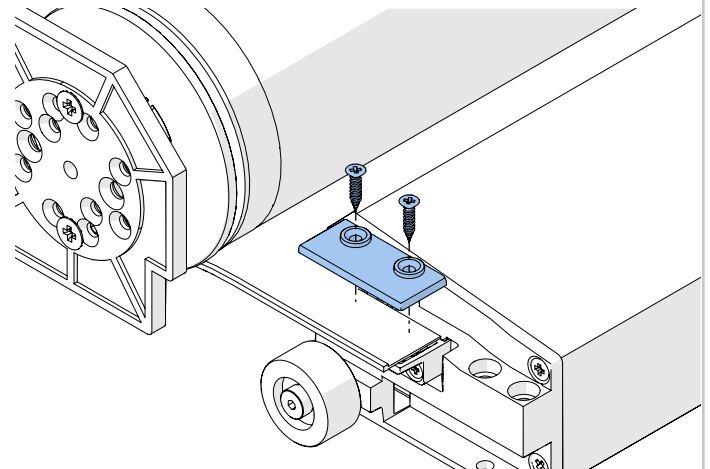
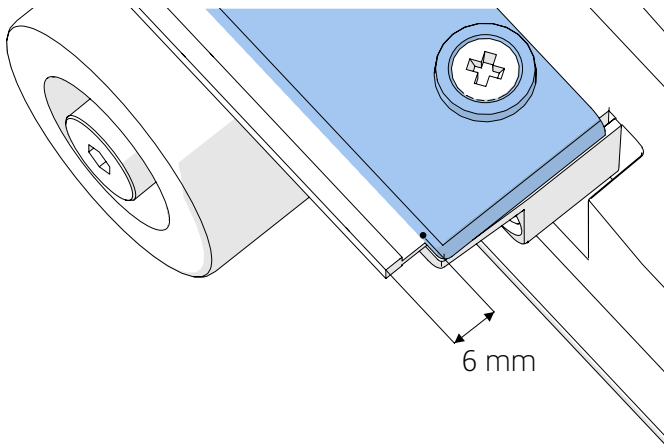

3.6 Cut off residual zipper

Cut the residual pieces of zipper as close to the end caps as possible.

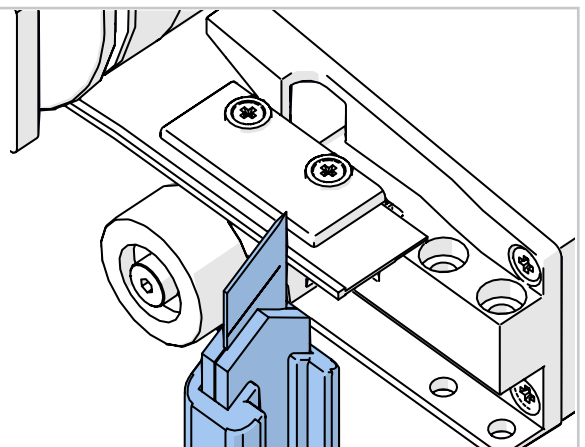

4.0 Drilling of holes for casing supports

Drill the 6 mm holes on the left and right-hand side. Then only drill the 9 mm hole in the top cover on the side where the motor cable runs through the top cover.

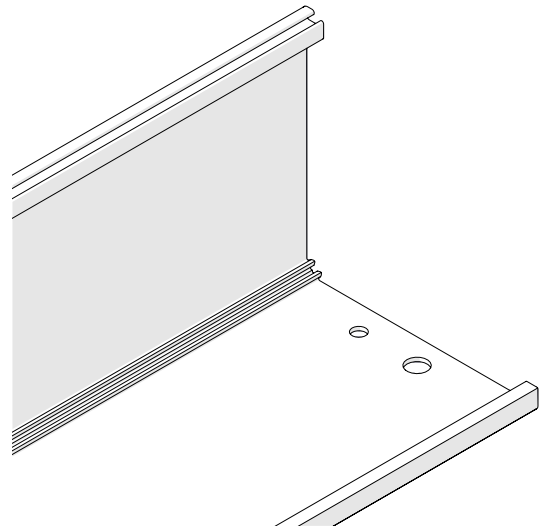
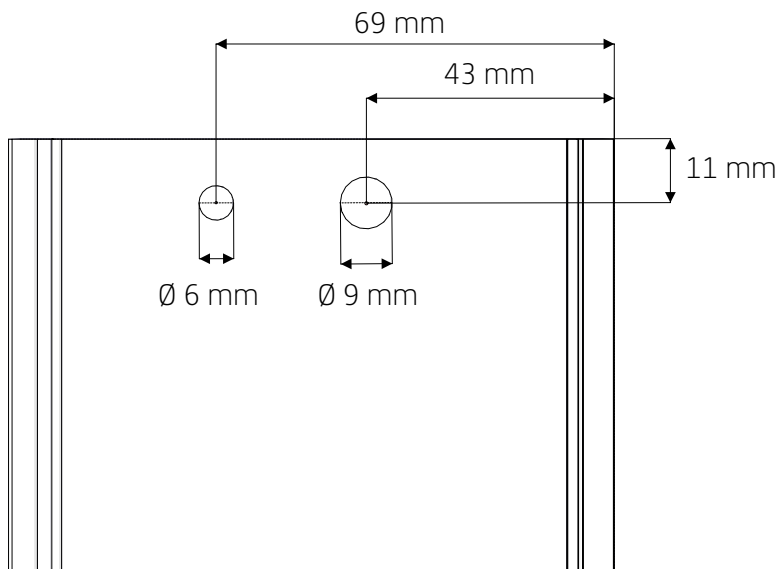

4.1 Installation of cover supports

Install the cover supports on both sides of the top cover using 3.5 x 16 mm self-tapping screws (countersunk head/cross-head).

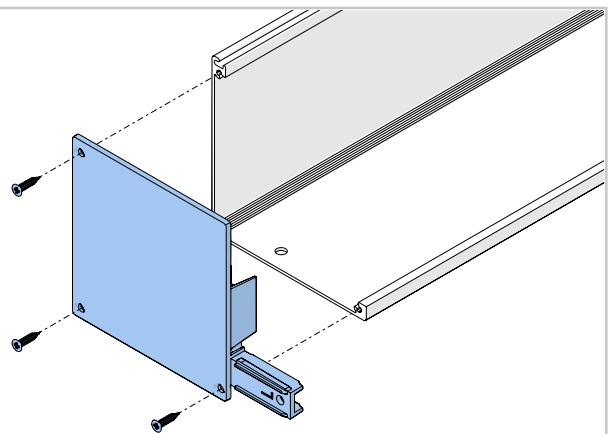

4.2 Fastening of casing supports

Fasten the casing supports using M5 x 12 mm metal screws (countersunk head/cross-head), M5 low square nuts and M5 retaining washers.

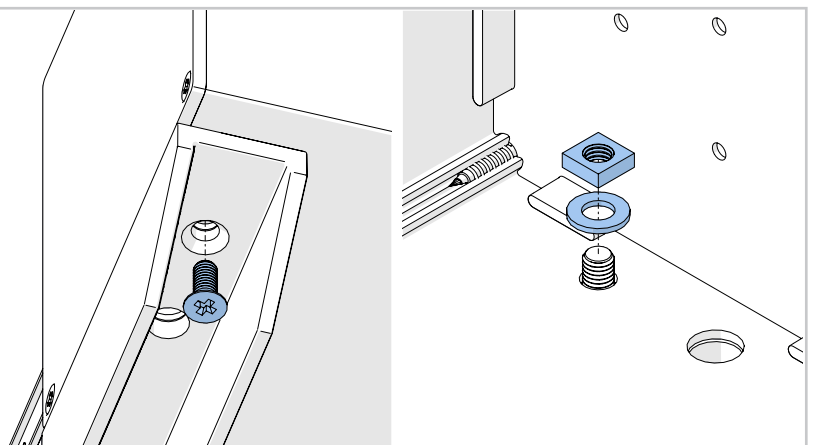

Assembly of casing

4.3 Fitting of fabric roller in top cover

Fit the fabric roller into the top cover as shown in the picture. Lead the motor cable through the 9 mm hole in the top cover.

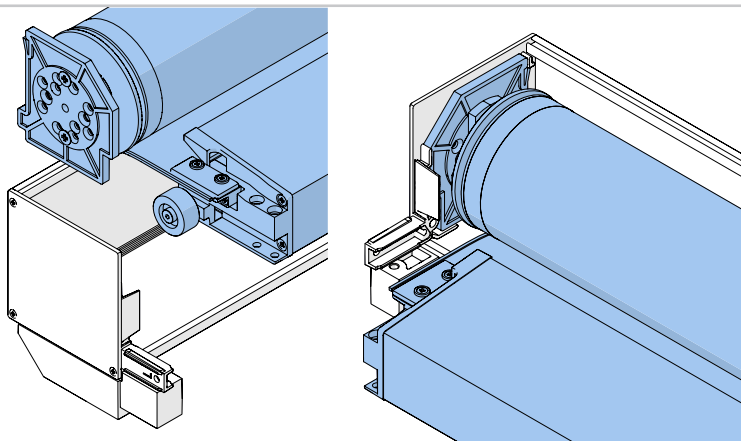

4.4 Mounting of bottom cover

Hook the bottom cover into the top cover as shown in the picture.

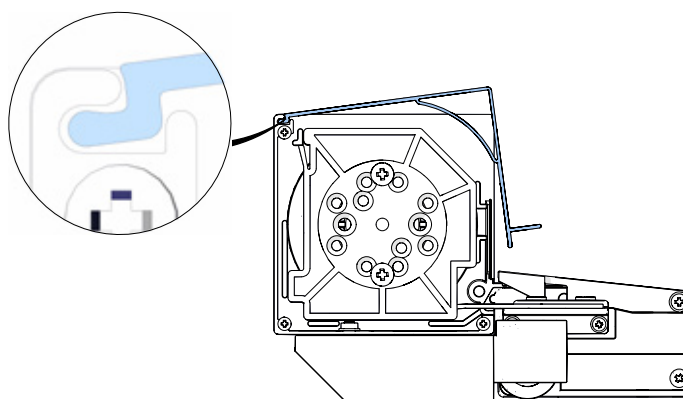

4.5 Fastening of bottom cover

Fasten the bottom cover on both sides using two 4.2 x 13 mm self-tapping screws (cylinder head/cross-head).

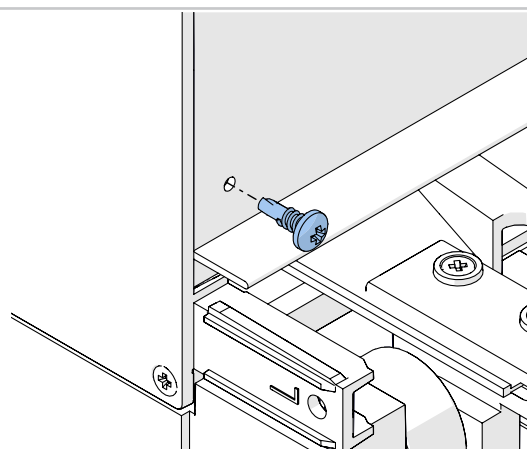

Assembly of side guides

5.0 Drilling of side guides

Drill 7 mm holes into the side guides to fasten the casing supports. Position the holes on the drill line and 27 mm from the ends of the side guides.

ATTENTION! There are left-handed and right-handed side guides.
ATTENTION! Thoroughly clean and remove any chips from the insides of the side guides after drilling.

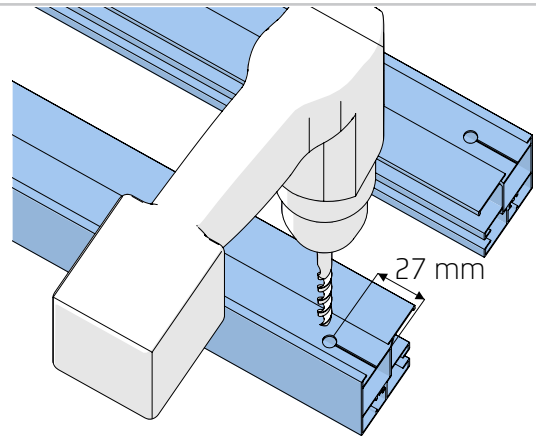

5.1 Installation of mounting plates

Install two mounting plates per side guide as shown in the picture.

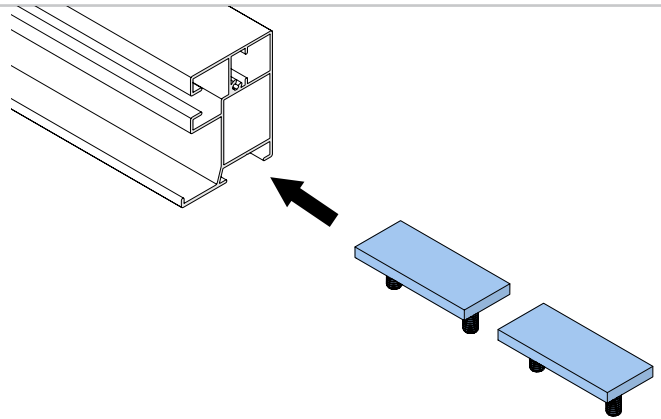

5.2 Mounting of inlet guides

Mount the inlet guides onto the plastic guides using 2.9 x 19 mm self-tapping screws (countersunk head/cross-head).

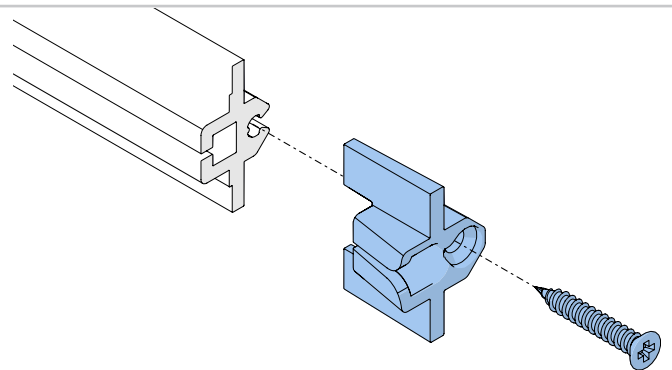

5.3 Attaching of neoprene strips

Attach neoprene strips to the plastic guides every 50 cm as shown in the picture. Keep the upper strips 10 cm away from the inlet guides.

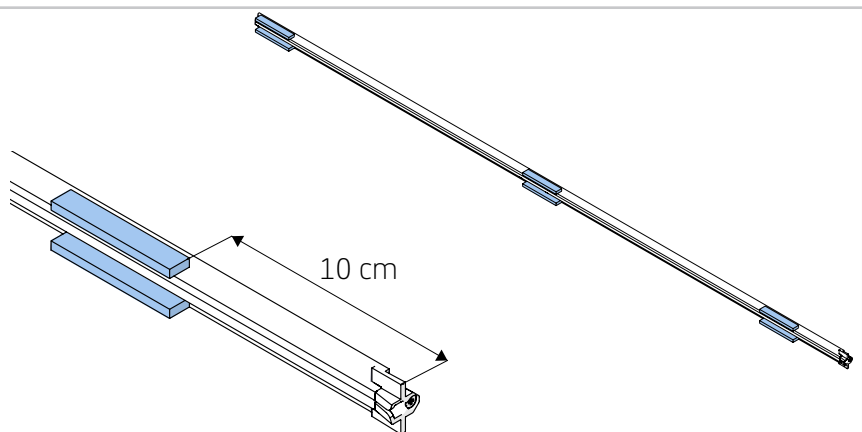

Assembly of side guides

5.4 Fitting of plastic guides

Slide the plastic guides into the side guides as shown in the picture. Make sure that the inlet funnels of the plastic guides are on the same side as the holes drilled in **step 5.0**.

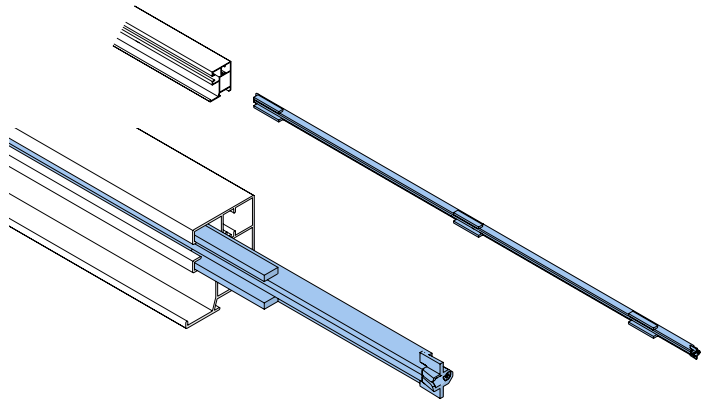

5.5 Fitting of gas springs

Install the gas springs on the other side of the side guides as shown in the picture and fasten them with 3.5 x 16 mm self-drilling screws (cylinder head/cross-head). During installation, make sure that the steel cable of the gas spring does not touch the edge of the side guide.

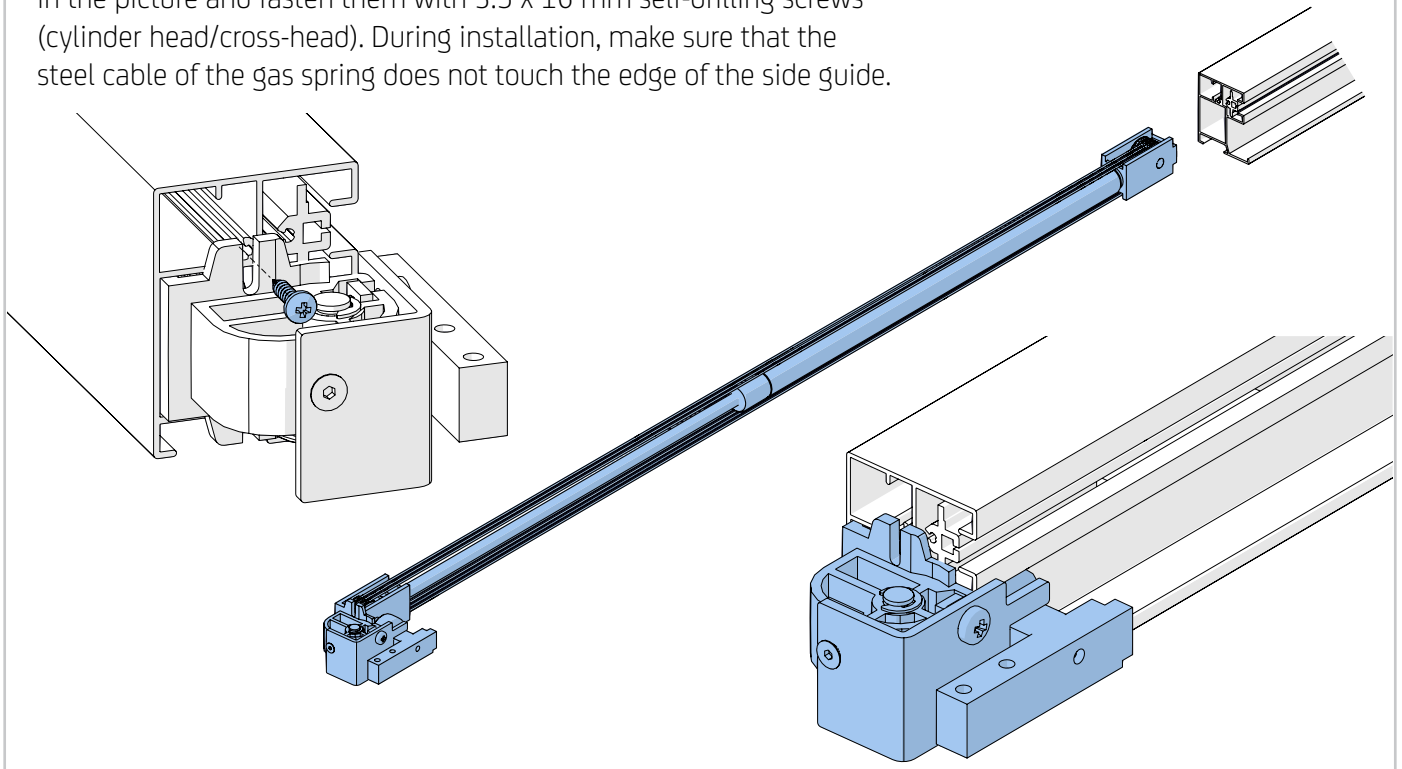



SolidSky installation



Installation of casing

1.0 Preparing assembly

Before mounting the SolidSky assess whether the existing construction is suitable. Mount the SolidSky flat and perpendicular, check if this is the case by measuring angled.

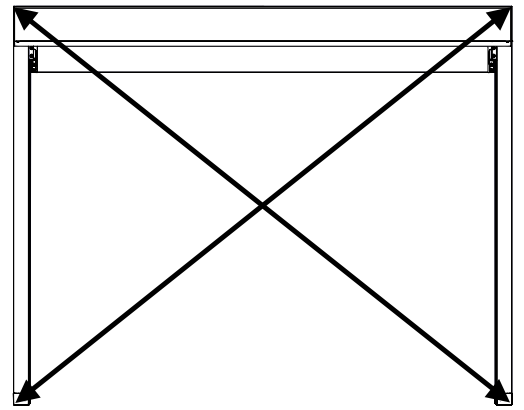

1.1 Fitting of casing

Slide the casing into the side guides as shown in the picture. Make sure that the zipper of the fabric runs properly into the zipper guides.

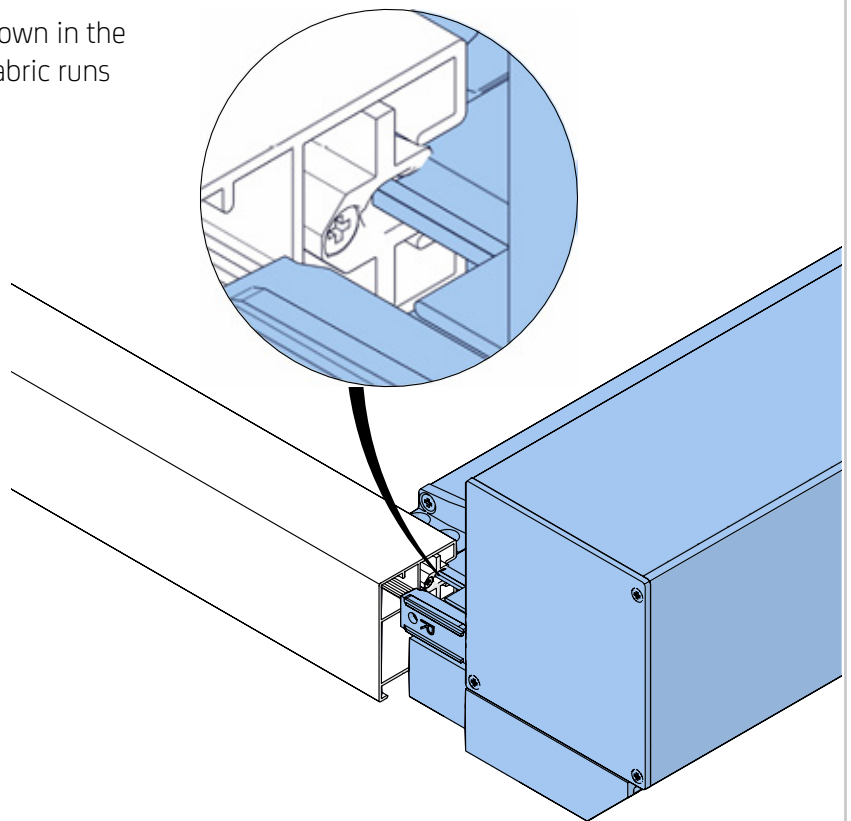

1.2 Fastening of casing

Fasten the casing onto the side guides using M6 x 20 mm hexagonal bolts and M6 retaining washers.

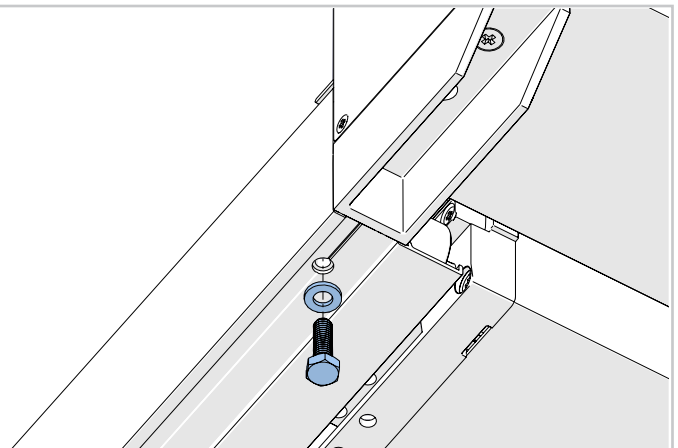

2.0 Installation of supports

Install the supports onto the canopy. The upper supports should be about 150 mm from the rear of the top cover.

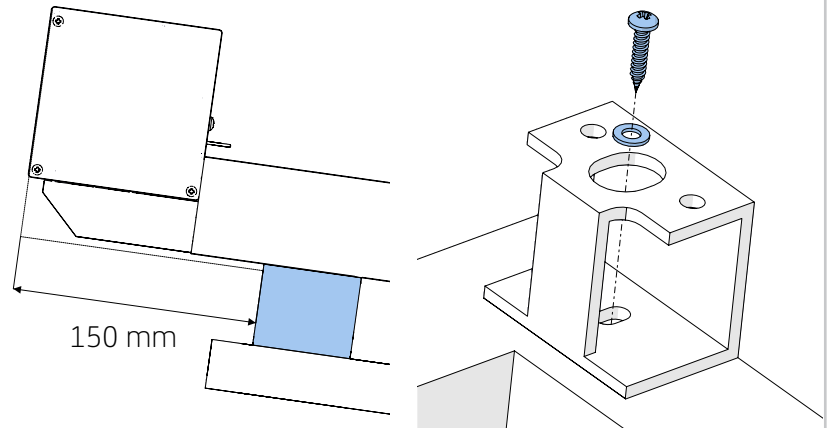

2.1 Fitting of SolidSky

Install the SolidSky onto the supports using M6 hexagonal nuts and M6 retaining washers.

ATTENTION! Above the 2000 mm projection, 3 supports per side guide.

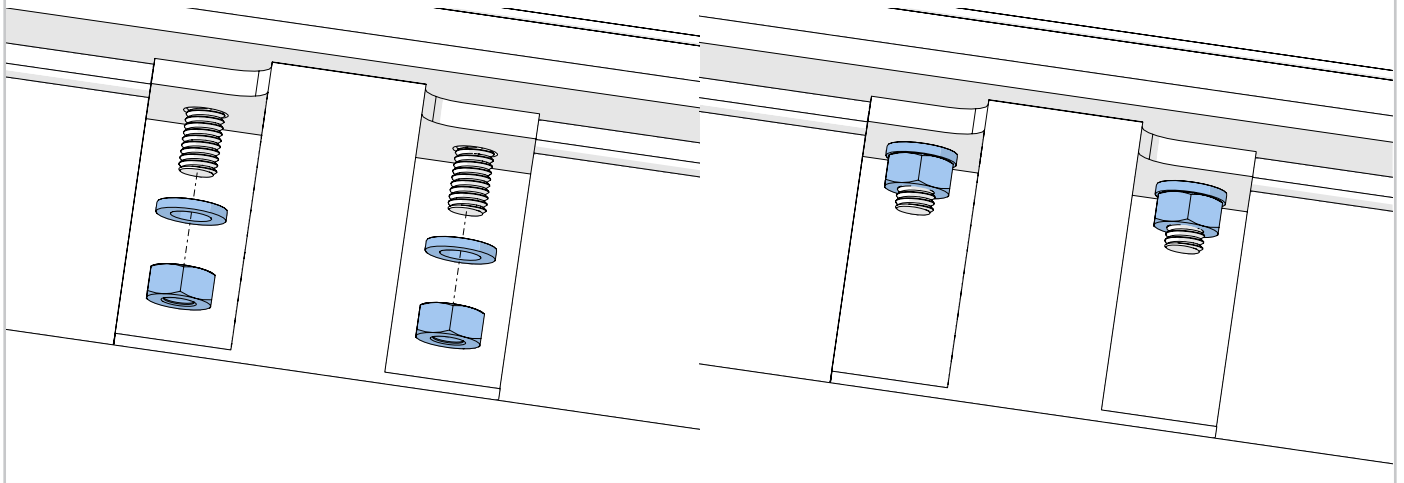
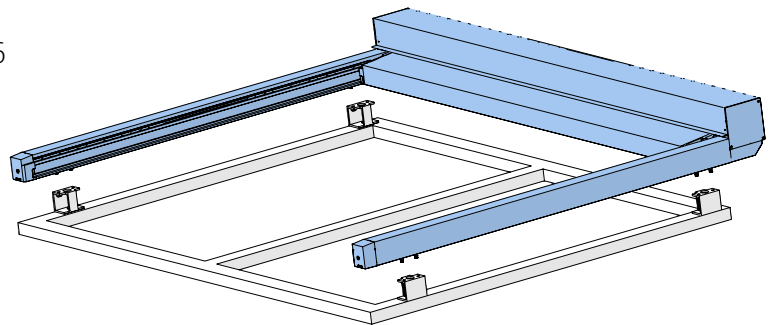

SolidSky installation

2.2 Tensioning of fabric

Run the front profile downwards (pull the front profile to keep the fabric taut) and fasten the gas spring tensioners to the front profile using two M5 x 35 mm Allen screws (cylinder head). Refer to the enclosed motor manufacturer's manual for adjustment of the motor endpoints.

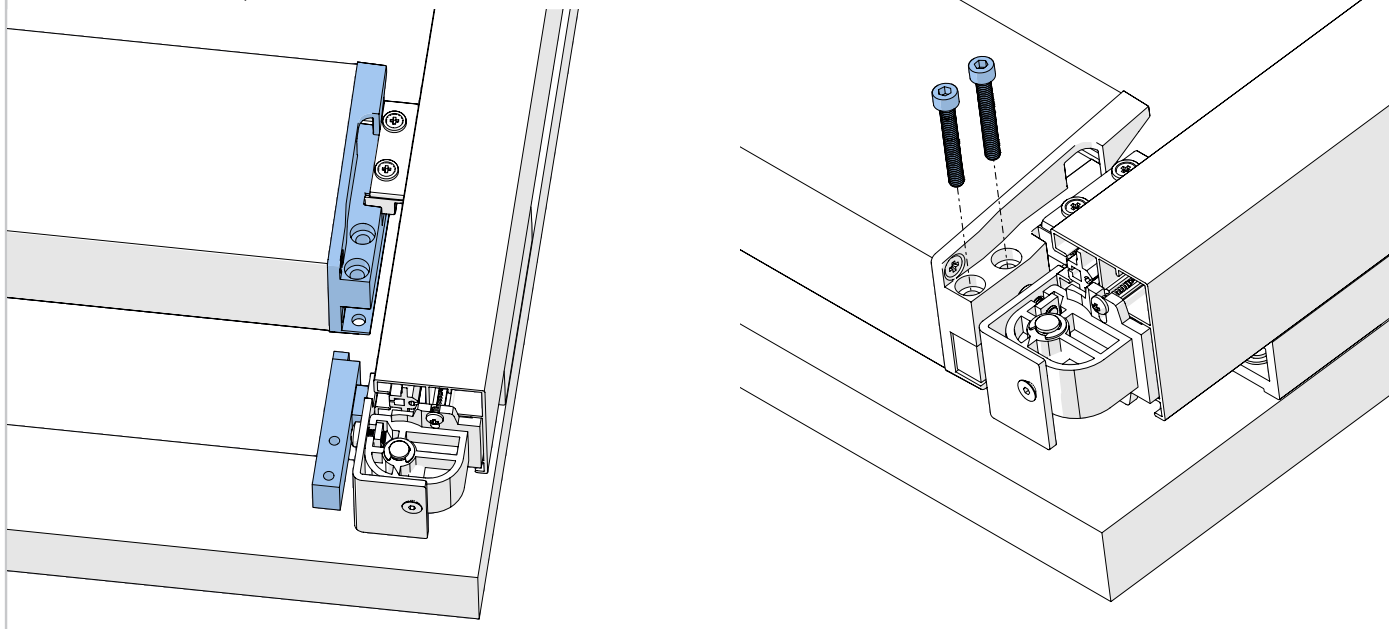

2.3 Disassembly of locking plates

Let the front profile run a little upwards to allow the locking plates of the tensioning system to be removed. Keep the locking plates with all their parts.

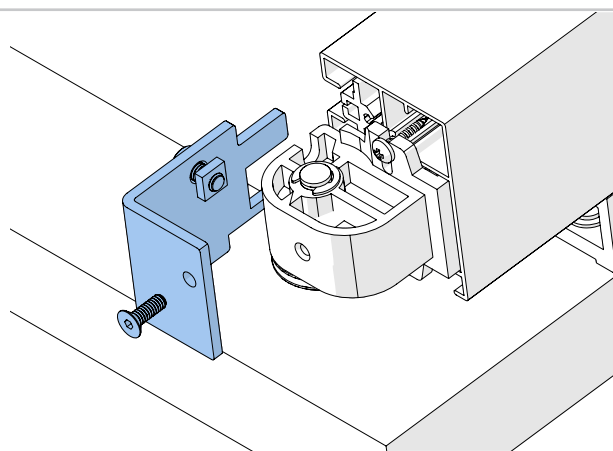

2.4 Mounting of covers

Mount the covers as shown in the picture. Use the M4 x 12 mm Allen screws (countersunk head) that were in the locking plates for this.

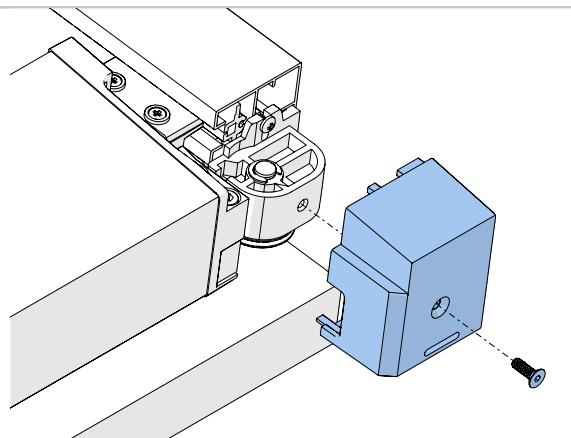





Appendices





	AVZ	SSH
6	6252540-000	5800270-000
7	6252520-000	5800240-000
8	4452697-080	5315600-000
9	4452695-080	5315100-511
10	4000213-000	1340600-000
11	4000954-000	1485200-000
12	4452083-000	1320400-000
13	4000151-000	1331500-000
14	4211130-080	2315800-000
15	4452487-000	5217900-000
16	4452481-008	5771060-735
17	4452486-008	5762000-735
18	4452070-000	1320411-000
19	6253232-000	6678750-000
20	4210498-080	1271900-000
21	4452445-068	5749778-000
22	4452464-008	5719900-000
23	4000909-000	1482000-000
24	Somity LT 50	
25	4452580-000	5710500-000
26	4452582-000	5710600-000
27	4217655-000	5800050-000

 AVZ Aluminium Verkoop Zuid B.V. Kanaalwijk 11 5883 CR Best • Nederland	Project:		Datum:	Tekenaar:
	Am. Projectie:  Formaat: A3 Maat: mm 1:50	Tekening nummer: -000		Revisie:



SolidSky Assembly & Installation Manual V.08

AVZ-GROUP

Kanaaldijk 11 • 5683 CR Best • The Netherlands

T +31 499 328 600 **E** verkoop@avz.nl

